

Deutscher Y22

22" SELF PROPELLED GRASS CUTTER

MODELS 36212 Swivel Front Wheels 36012 Fixed Front Wheels
MODEL 133702 - BRIGGS & STRATTON ENGINE



MAINTENANCE INSTRUCTIONS AND PARTS LIST

SAFETY INSTRUCTIONS

- Never mow while barefoot or wearing open sandals! or thongs. Wear long trousers and heavy shoes (preferably safety footwear).
- Know your controls. Read this booklet carefully. Learn how to stop engine quickly in any emergency.
- Make sure the lawn is clear of sticks, stones, bones, wire and debris. They could be thrown by the blades.
- Stop the engine and disconnect spark plug wire before checking or working on the mower.
- Before using, always visually inspect to see that blades, blade pins and cutter assembly are not worn or damaged. Replace worn or damaged blades and pins in sets to preserve balance.
DAMAGED BLADES AND WORN PINS ARE MAJOR HAZARDS.
- Check all nuts, bolts and screws often; always be sure the mower is in safe operating condition. Use only replacement parts made and guaranteed by DEUTSCHER.
- Add fuel BEFORE starting engine. Avoid spilling petrol and do not fill the tank while engine is running or while you are smoking.
- Do not mow whilst people, especially children, or pets are in the mowing area.
- Never use the mower unless the grass catcher, or guards provided by the manufacturer, are in position.
- Disengage all blade and drive clutches before starting.
- Start the engine carefully with feet well away from the blades.
- Do not operate engine in a confined space where exhaust fumes (carbon monoxide) can collect.
- Stop the engine whenever you leave the mower, even for a moment.
- Disengage cuttershaft drive before moving mower across gravel drives, walks or roads.
- Do not allow children or people unfamiliar with these instructions to use the mower.
- On slopes or wet grass, be extra careful of your footing.
- Never cut grass by pulling the mower towards you.
- Be extremely careful when using a mower on slopes.
- Do not over-speed the engine or alter governor settings. Excessive speed is dangerous and shortens mower and engine life.
- It is advisable to wear suitable eye protection when operating a mower.
- Turn the fuel off at the conclusion of mowing and reduce the throttle setting during engine run-out.
- Store fuel in a cool place in a container specifically designed for the purpose. In general, plastic containers are unsuitable.
- Never pick up or carry a mower when it is operating

NOTE: These safety instructions are recommended by the Standards Association of Australia for use with pedestrian and ride-on mowers.

Deutscher Y22

PRE START CHECK

Your DEUTSCHER Grass Cutter comes to you tested and ready to operate with engine and gear box already filled with oil.

Before operating the machine, thoroughly check the area to be cut and remove any object that may cause damage to the machine.

1. Use fresh fuel - do not use 2 stroke fuel.
2. Read Engine Instruction Book.
3. Ensure that gear lever is in neutral position.
4. Set blades to maximum cutting height.
5. Pull belt release lever towards handles to disengage cutter belt.
6. Set throttle lever to midway position.
7. Start engine according to instructions and allow time for warm up before engaging belt release lever, which locks in working position.

Do not operate engine at maximum revs unless heavy conditions warrant it.

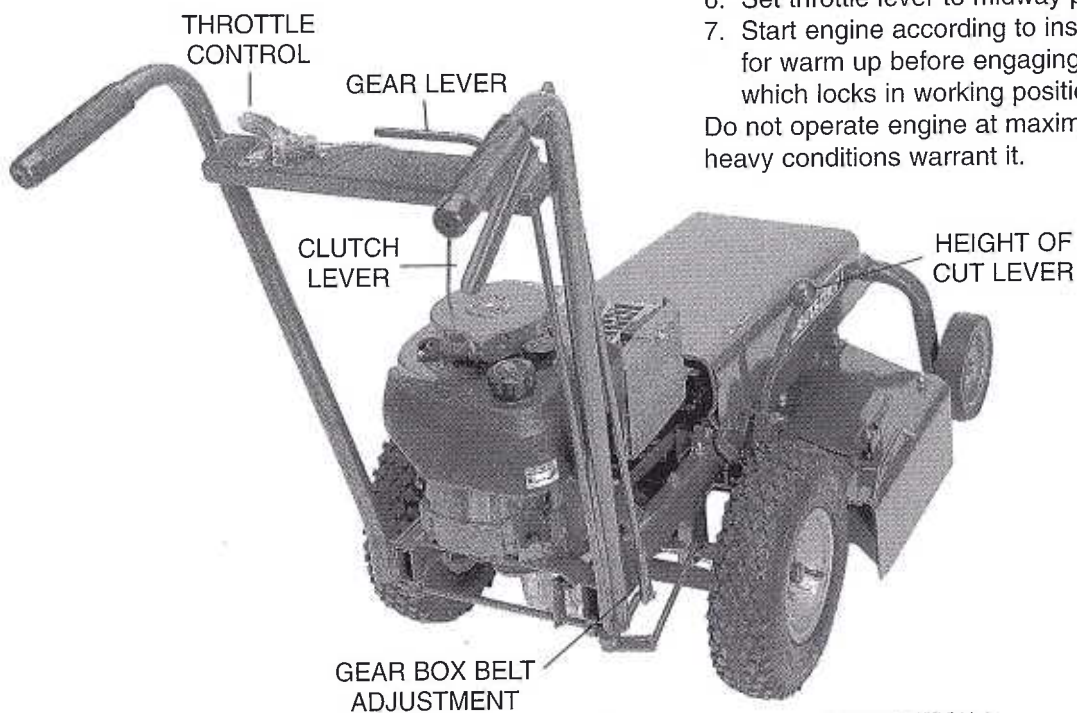

ILLUSTRATION 1

Important

OIL: Your engine needs GOOD OIL - CLEAN OIL - ENOUGH OIL. Each five (5) hours add oil to top level filler opening.

AIR CLEANER: Service air cleaner every 25 running hours under normal conditions. Under dusty conditions, every 4 hours. (Refer to Engine Instruction Manual).

PETROL: Use fresh fuel.

COOLING FINS, SCREEN: This engine is air cooled. Keep the blower screen, fins on flywheel, cylinder head and block, free from grass or dirt and grease. Check every 8 hours. Clogged fins and screen block air-flow, causing over-heating, which may result in serious damage to the engine. Remove blower screen and clean regularly.

OPERATING INSTRUCTIONS AND MAINTENANCE GUIDE

BELT ADJUSTMENT Maintain belts at correct tension. Too much or too little wastes power.

GEAR BOX BELT Loosen rear nut and tighten front nut (see Illustration 1). **MAKE SURE BELT IS ENTIRELY FREE WHEN CLUTCH LEVER DISENGAGED. DO NOT OVER-TIGHTEN BELT.**

CUTTER BELT Swing back top cover. Pull belt release lever towards handles to disengage belt. Loosen rear nut and tighten front nut. Adjust cutter spindle brake by adjusting nuts on brake rod (Y26) until brake operates when belt lever is disengaged.

BLADES Before checking blades

1. Set throttle control on stop.
2. Disconnect spark plug wire.

Keep blades sharp. Rotate cutter till blade appears at side chute. Unscrew special brass nut, remove spring washer and blade assembly can be taken out from underneath. Make sure bolt is not worn (replace if necessary). Oil threads and replace by reverse procedure. Screw brass nut until level with thread of the bolt and ensure the offset of the brass nut is facing out.

Both edges of blades can be used by turning blade over.

DIAGRAM OF BLADE ASSEMBLY

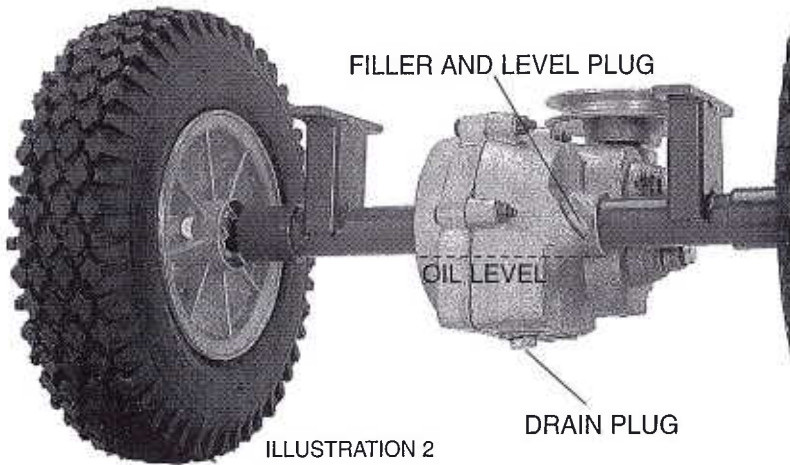
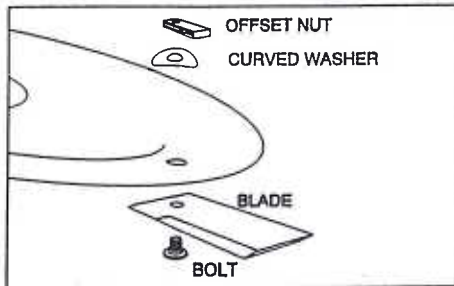

ILLUSTRATION 2

LUBRICATION

ENGINE According to Engine Instruction Manual.

GEAR BOX Use Castro E.P.X. 85W/140 gear oil. Check oil level every 2 weeks. Drain & re-fill every 100 hrs. Fill to plug level (see illustration 2).

FRONT WHEELS Grease every 8 hours.

GEAR CONTROL LEVER & LINKAGE Oil all joints daily.

HEIGHT CONTROL LEVER & LINKAGE Oil all joints daily.

CLUTCH LEVER & LINKAGE Oil all joints daily.

CUTTER SPINDLE Put height adjustment lever in low position. Swing back main cover guard. Nipple on spindle housing is then accessible. Grease every 50 hours till grease comes out the overflow hole.

LUBRICATION INTERVAL CHART

	Daily	50hrs	100hrs
GEAR BOX			
Check		X	
Change			X
CUTTER SPINDLE		X	
FRONT WHEELS	X		
GEAR CONTROL LINKAGE	X		
HEIGHT CONTROL LINKAGE	X		
CLUTCH CONTROL LINKAGE	X		

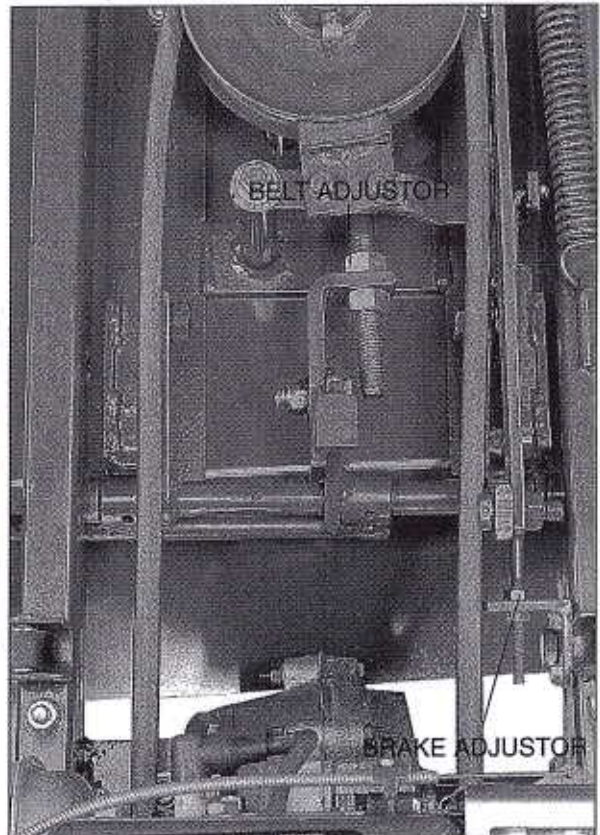
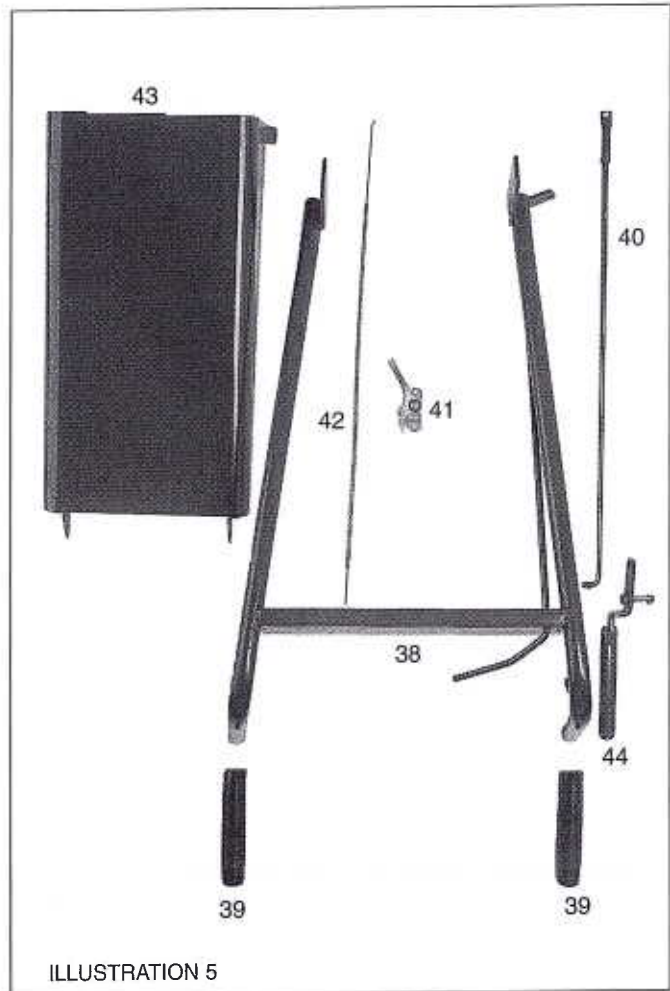
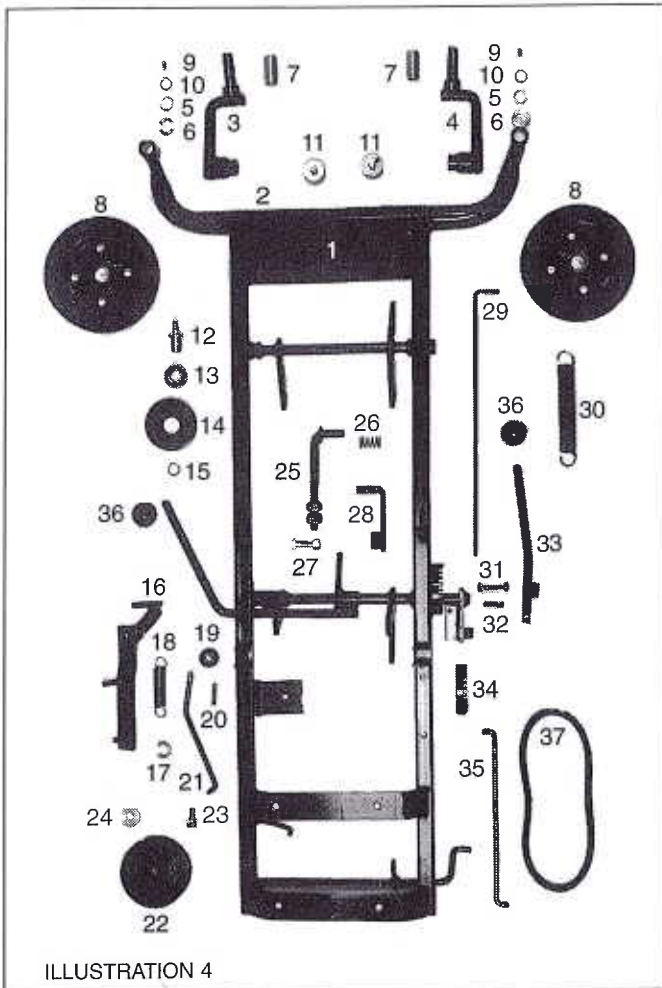

ILLUSTRATION 3

MAIN FRAME

HANDLE & CONTROL ASSEMBLY



ILLUST. NO.	DESCRIPTION	PART NO.
-------------	-------------	----------

ILLUST. NO.	DESCRIPTION	PART NO.
-------------	-------------	----------

1	Main frame	Y500
-	Main frame (Fixed front wheels)	Y01
2	Front axle beam	Y501
3	King pin & stub axle (Lefthand)	Y502
4	King pin & stub axle (Righthand)	Y503
5	Washer	Y504
6	Thrust washer	Y505
7	Bush	RD146
8	Wheel complete	MR50
-	Wheel bearing	MD18
-	Tyre	R57
9	Grease nipple	R13
10	Circlip 16mm	RD136
11	Bolt & washer	G02
12	Clutch pulley pin	H59
13	Clutch pulley bearing (6202-2RS)	H60
14	Clutch pulley	H61
15	Circlip 15mm	H62
16	Clutch pulley arm	Y02
17	Washer 3/8"	T529
18	Clutch spring	Y03
19	Roller	H07
20	Pin	H08
21	Horizontal clutch rod	Y04
22	Engine pulley	Y05

23	Bolt	DD110
24	Washer	DD111
25	Push rod	Y06
26	Push rod spring	D134
27	Bolt	Y07
28	Push rod connector	H26
29	Raise & lower con rod	Y08
30	Spring	D50
31	Bolt	Y09
32	Spring	RD147
33	Raise & lower lever	Y11
34	Height rack	Y19
35	Horizontal gear rod	Y12
36	Knob	Y13
37	Gearbox V-belt (A23)	Y40
38	Handles	Y14
39	Handle grip	D19
40	Vertical clutch rod	Y15
41	Throttle control lever	Z08
42	Throttle control cable	H41
43	Top cover	Y17
44	Clutch lever	Y18

CUTTER HEAD

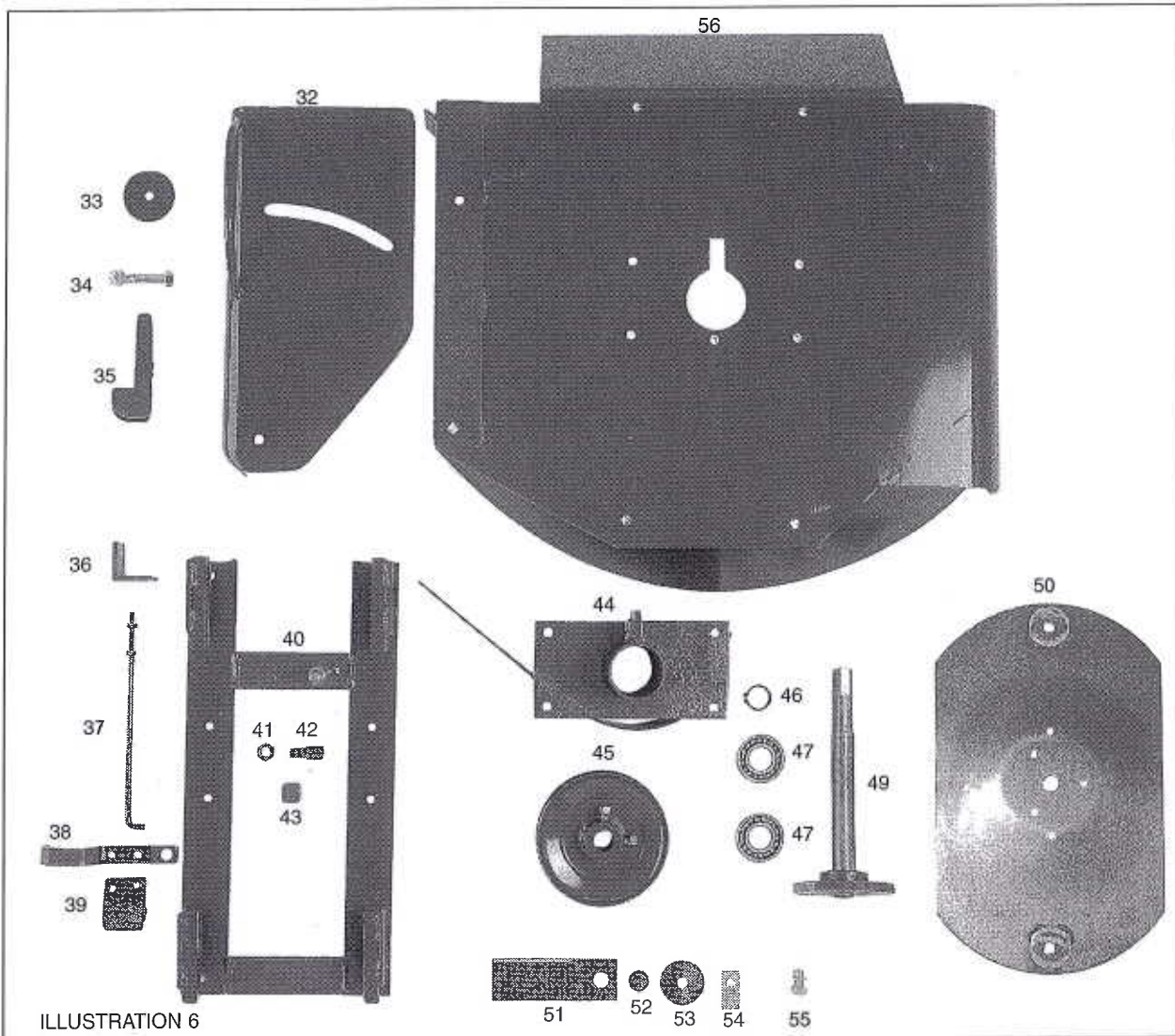

ILLUSTRATION 6

ILLUST. NO.	DESCRIPTION	PART NO.	ILLUST. NO.	DESCRIPTION	PART NO.
32	Side chute	Y21	45	Main spindle pulley	C10/5
33	Washer	Y22	46	Circlip 25mm	R29
34	Bolt	Y23	47	Spindle bearings	R28
35	Lever	Y24	49	Main spindle & flange	Y31
36	Brake rod anchor	Y25	50	Rotor	Y32
37	Brake rod	Y26	51	Blade	R01
38	Brake arm	Y27	52	Blade bolt	D02
39	Brake shoe	Y28	53	Blade washer	D03
40	Raise & lower frame	Y29	54	Blade nut	D04
41	Nut 7/16" UNF	H23	55	Rotor bolt x 3	G36
42	Pin	H22	56	Main guard	Y20
43	Square lift block	H21		Cutter drive belt (B59) Not illustrated	Y41
44	Main spindle bearing housing	Y30			

GEAR BOX & DIFFERENTIAL

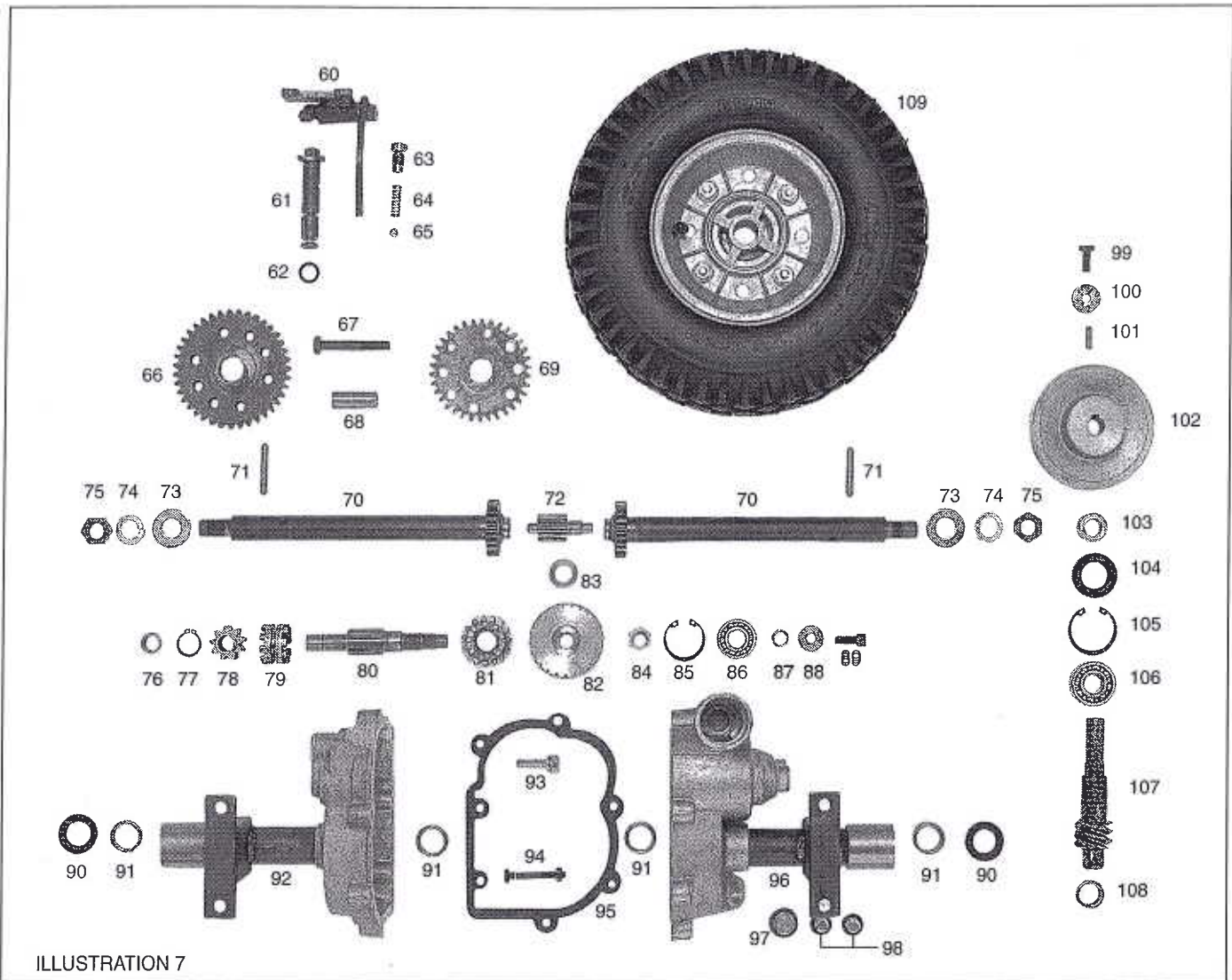

ILLUSTRATION 7

NO.	DESCRIPTION	NO.	NO.	DESCRIPTION	NO.	NO.	DESCRIPTION	NO.
60	Gear selector	YD70	78	Low gear pinion	HD87	96	R.H. Housing	YD103
61	Forward tappet & end	HD80	79	Double clutch	HD88	97	3/4" UNF plug & washer	HD104
62	O Ring	RD133	80	Forward spindle	YD89	98	1/2" BSF plug & washer	MDD98
63	Spring holder	HD84	81	High gear pinion & clutch	HD90	99	Pulley screw	HD105
64	Spring	HD83	82	Bronze worm gear	YD91	100	Collar washer	HD106
65	Ball	HD82	83	Hardened worm gear washer	HD114	101	Key	HD107
66	Low crown gear	HD78	84	Lock nut	YD92	102	Pulley	HD108
67	Diff bolt 2 1/2" x 3/8" UNF x 4	HD75	85	Circlip 35mm	HD93	103	Spacer washer	HD109
68	Spacer sleeve x 4	MRD179	86	Ball bearing 6202	Z35	104	Oil seal 25 x 40 x 7mm	HD110
69	High crown gear	HD77	87	Bearing sleeve	HD115	105	Circlip 40mm	HD111
70	Axle (LH & RH are identical)	YD71	88	Washer	HD94	106	Ball bearing 6203	HD112
71	Axle pin	HD79	89	Screw	HD95	107	Input spindle & worm	YD113
72	Diff spider gear x 4	RD178	90	Oil seal 7/8" X 1 3/8" X 1/4"	DD90	108	Bearing	RD194
73	Axle washer	RD175	91	Axle roller bearing B148	Z50	109	Rear wheel C/W tyre & tube	Z80
74	Axle spring washer	HD124	92	L.H. Housing	YD98	*	Gear Box complete	YD120
75	Axle nut 5/8" UNF	RD174	93	Bolt 1 1/4" X 5/16" WHIT	HD74	*	Tyre only	MDD116
76	Roller bearing B98	HD85	94	Bolt 2" x 1/4" UNF x 6	YD72	*	Tube only	RD204
77	Circlip 9/16"	HD86	95	Gasket	HD71	*	Wheel only	Z81