

Deutscher H26

26" SELF PROPELLED GRASS CUTTER

MODELS 36055, 36255, 36256 - BRIGGS & STRATTON ENGINE
MODELS 36057, 36257, 36157, 36258 - HONDA ENGINE



MAINTENANCE INSTRUCTIONS AND PARTS LIST

SAFETY INSTRUCTIONS

- Never mow while barefoot or wearing open sandals! or thongs. Wear long trousers and heavy shoes (preferably safety footwear).
- Know your controls. Read this booklet carefully. Learn how to stop engine quickly in any emergency.
- Make sure the lawn is clear of sticks, stones, bones, wire and debris. They could be thrown by the blades.
- Stop the engine and disconnect spark plug wire before checking or working on the mower.
- Before using, always visually inspect to see that blades, blade pins and cutter assembly are not worn or damaged. Replace worn or damaged blades and pins in sets to preserve balance.

DAMAGED BLADES AND WORN PINS ARE MAJOR HAZARDS.

- Check all nuts, bolts and screws often; always be sure the mower is in safe operating condition. Use only replacement parts made and guaranteed by DEUTSCHER.
- Add fuel BEFORE starting engine. Avoid spilling petrol and do not fill the tank while engine is running or while you are smoking.
- Do not mow whilst people, especially children, or pets are in the mowing area.
- Never use the mower unless the grass catcher, or guards provided by the manufacturer, are in position.
- Disengage all blade and drive clutches before starting.
- Start the engine carefully with feet well away from the blades.

- Do not operate engine in a confined space where exhaust fumes (carbon monoxide) can collect.
- Stop the engine whenever you leave the mower, even for a moment.
- Disengage cuttershaft drive before moving mower across gravel drives, walks or roads.
- Do not allow children or people unfamiliar with these instructions to use the mower.
- On slopes or wet grass, be extra careful of your footing.
- Never cut grass by pulling the mower towards you.
- Be extremely careful when using a mower on slopes.
- Do not over-speed the engine or alter governor settings. Excessive speed is dangerous and shortens mower and engine life.
- It is advisable to wear suitable eye protection when operating a mower.
- Turn the fuel off at the conclusion of mowing and reduce the throttle setting during engine run-out.
- Store fuel in a cool place in a container specifically designed for the purpose. In general, plastic containers are unsuitable.
- Never pick up or carry a mower when it is operating

NOTE: These safety instructions are recommended by the Standards Association of Australia for use with pedestrian and ride-on mowers.

Deutscher H26

PRE START CHECK

Your DEUTSCHER Grass Cutter comes to you tested and ready to operate with engine and gear box already filled with oil.

Before operating the machine, thoroughly check the area to be cut and remove any object that may cause damage to the machine.

1. Use fresh fuel - do not use 2 stroke fuel.
2. Read Engine Instruction Book.
3. Ensure that gear lever is in neutral position.
4. Set blades to maximum cutting height.
5. Pull belt release lever towards handles to disengage cutter belt.
6. Set throttle lever to midway position.
7. Start engine according to instructions and allow time for warm up before engaging belt release lever, which locks in working position.

Do not operate engine at maximum revs unless heavy conditions warrant it.

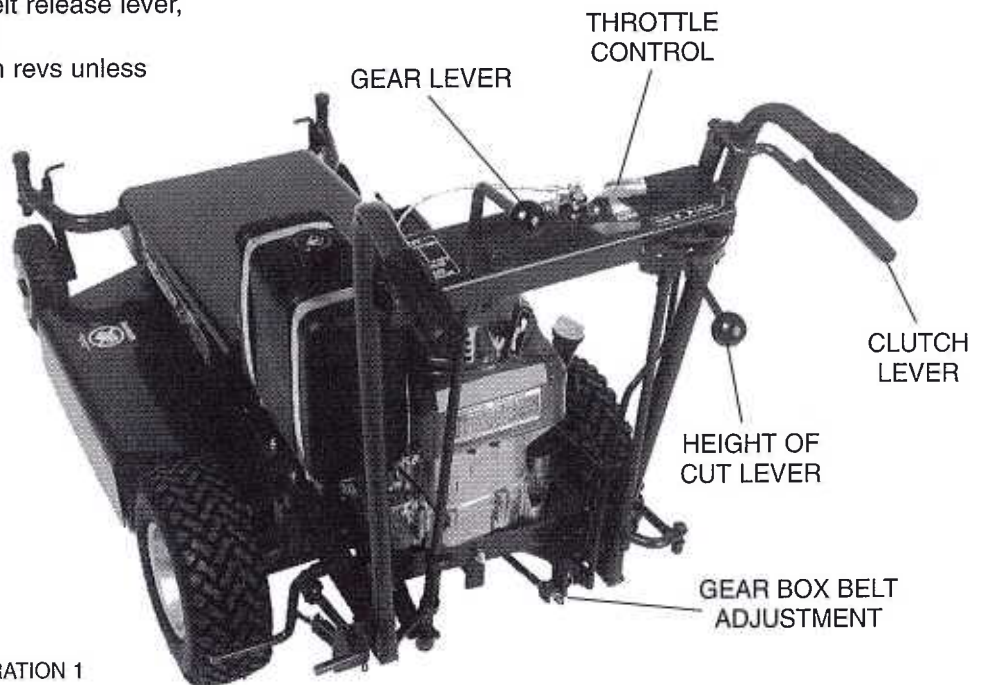

ILLUSTRATION 1

Important

OIL: Your engine needs GOOD OIL - CLEAN OIL - ENOUGH OIL. Each five (5) hours add oil to top level filler opening.

AIR CLEANER: Service air cleaner every 25 running hours under normal conditions. Under dusty conditions, every 4 hours. (Refer to Engine Instruction Manual).

PETROL: Use fresh fuel.

COOLING FINS, SCREEN: This engine is air cooled. Keep the blower screen, fins on flywheel, cylinder head and block, free from grass or dirt and grease. Check every 8 hours. Clogged fins and screen block air-flow, causing over-heating, which may result in serious damage to the engine. Remove blower screen and clean regularly.

OPERATING INSTRUCTIONS AND MAINTENANCE GUIDE

BELT ADJUSTMENT Maintain belts at correct tension. Too much or too little wastes power.

GEAR BOX BELT Loosen rear nut and tighten front nut (see Illustration 1). **MAKE SURE BELT IS ENTIRELY FREE WHEN CLUTCH LEVER DISENGAGED. DO NOT OVER-TIGHTEN BELT.**

CUTTER BELT Swing back top cover. Pull belt release lever towards handles to disengage belt. Loosen rear nut and tighten front nut. Adjust cutter spindle brake by moving brake lever stop (H19) forward. With belt release lever forward, there should be 3/8" (10mm) free play between brake lever (H28) and stop (H19).

BLADES Before checking blades

1. Set throttle control on stop.
2. Disconnect spark plug wire.

Keep blades sharp. Rotate cutter till blade appears at side chute. Unscrew special brass nut, remove spring washer and blade assembly can be taken out from underneath. Make sure bolt is not worn (replace if necessary). Oil threads and replace by reverse procedure. Screw brass nut until level with thread of the bolt and ensure the offset of the brass nut is facing out.

Both edges of blades can be used by turning blade over.

DIAGRAM OF BLADE ASSEMBLY

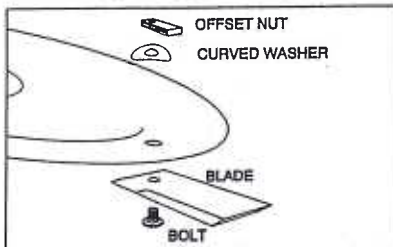

LUBRICATION

ENGINE According to Engine Instruction Manual.

GEAR BOX Use Castrol E.P.X. 85W/140 gear oil. Check oil level every 2 weeks. Drain & re-fill every 100 hrs. Fill to plug level (see illustration 2).

FRONT WHEELS Grease every 8 hours.

GEAR CONTROL LEVER & LINKAGE Oil all joints daily.

HEIGHT CONTROL LEVER & LINKAGE Oil all joints daily.

CLUTCH LEVER & LINKAGE Oil all joints daily.

CUTTER SPINDLE Put height adjustment lever in low position. Swing back main cover guard. Nipple on spindle housing is then accessible. Grease every 50 hours till grease comes out the overflow hole.

LUBRICATION INTERVAL CHART			
	Daily	50hrs	100hrs
GEAR BOX			
Check		X	
Change			X
CUTTER SPINDLE		X	
FRONT WHEELS	X		
GEAR CONTROL LINKAGE	X		
HEIGHT CONTROL LINKAGE	X		
CLUTCH CONTROL LINKAGE	X		

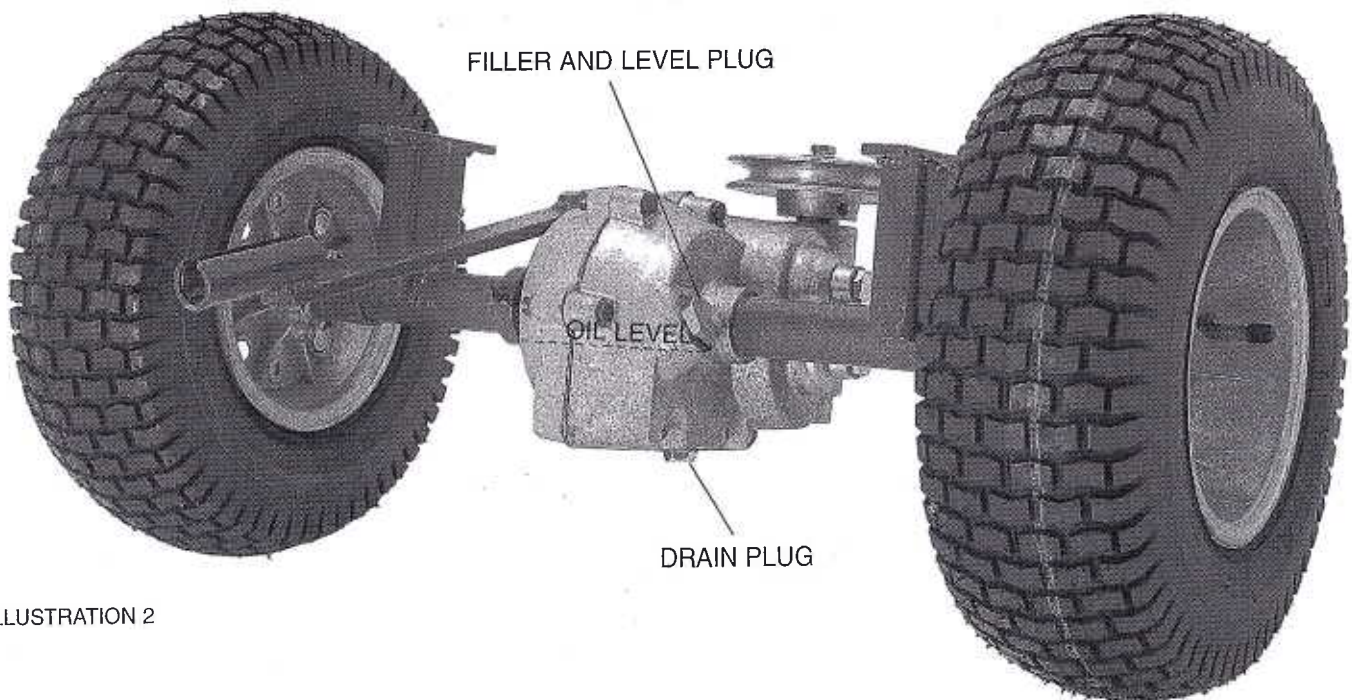

ILLUSTRATION 2

MAIN FRAME

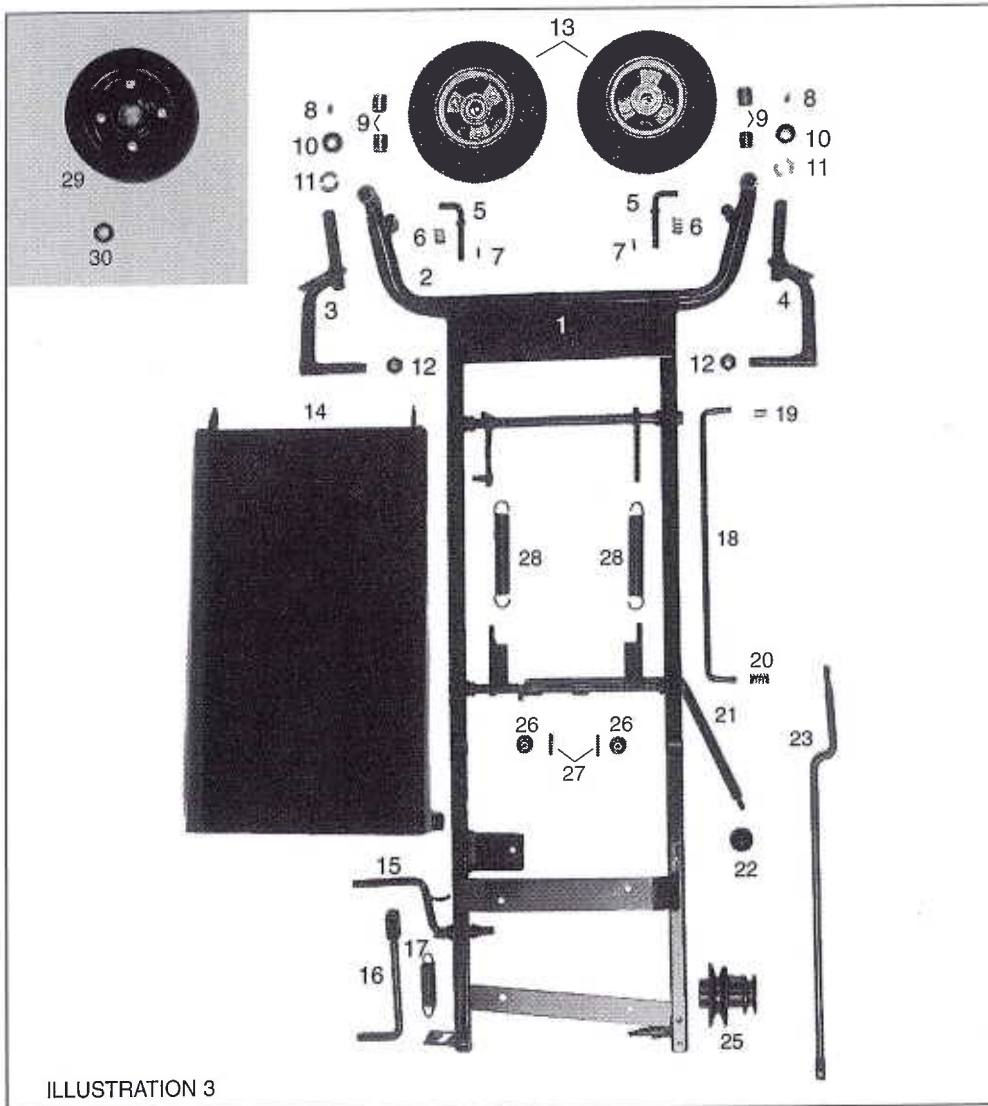

ILLUSTRATION 3

ILLUST. NO.	DESCRIPTION	PART NO.	ILLUST. NO.	DESCRIPTION	PART NO.
1	Main Frame	H500	15	Brake rod	H12
2	Front axle beam	H501	16	Brake pedal	H03
3	King pin & stub axle (Lefthand)	H502	17	Spring	H50
4	King pin & stub axle (Righthand)	H503	18	Raise & lower con rod (Front)	H04
5	Lock pin	H504	19	Sleeve	H14
6	Spring	H505	20	Spring	R87
7	Roll pin	H506	21	Belt release lever assembly	H13
8	Grease nipple	R13	22	Knob	D42
9	Bronze bush	R91	23	Connecting rod	H05
10	Collar	R92	25	Double engine pulley	H06
11	Thrust washer	R93	26	Roller	H07
12	Axle nut	RD174	27	Pin	H08
13	Wheel C/W tyre & tube	H510	-	Cutter drive belt (B66)	R14
-	Wheel only	H511	-	Gearbox drive belt (A33)	H09
-	Tyre	H512	28	Spring	D50
-	Tube	H513			
-	Sleeve for wheel centre	H514	29	Wheel (Fixed front option)	MD17
-	Grease nipple 90°	H515	30	Bolt & washer (Fixed front option)	G02
-	Wheel bolt (2" x 5/16")	H516	-	Bearing (6205Z) fixed front wheel	MD18
-	Wheel bearing (6203Z)	G71	-	Tyre only	MD19
14	Top cover (Briggs & Stratton engine)	H02			
-	Top cover (Honda engine)	H02A			

GEAR BOX & DIFFERENTIAL

LIMITED SLIP DIFFER

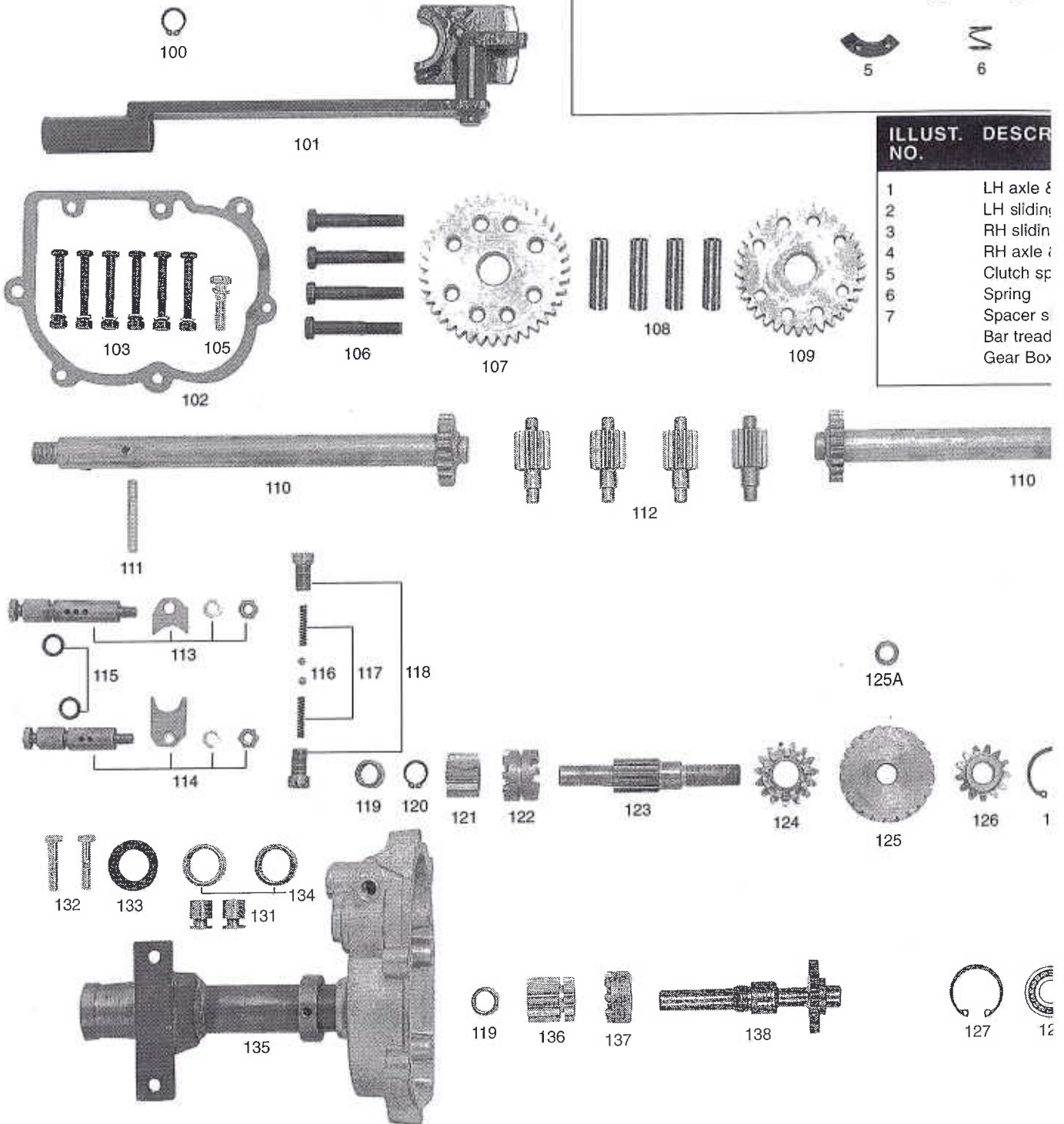
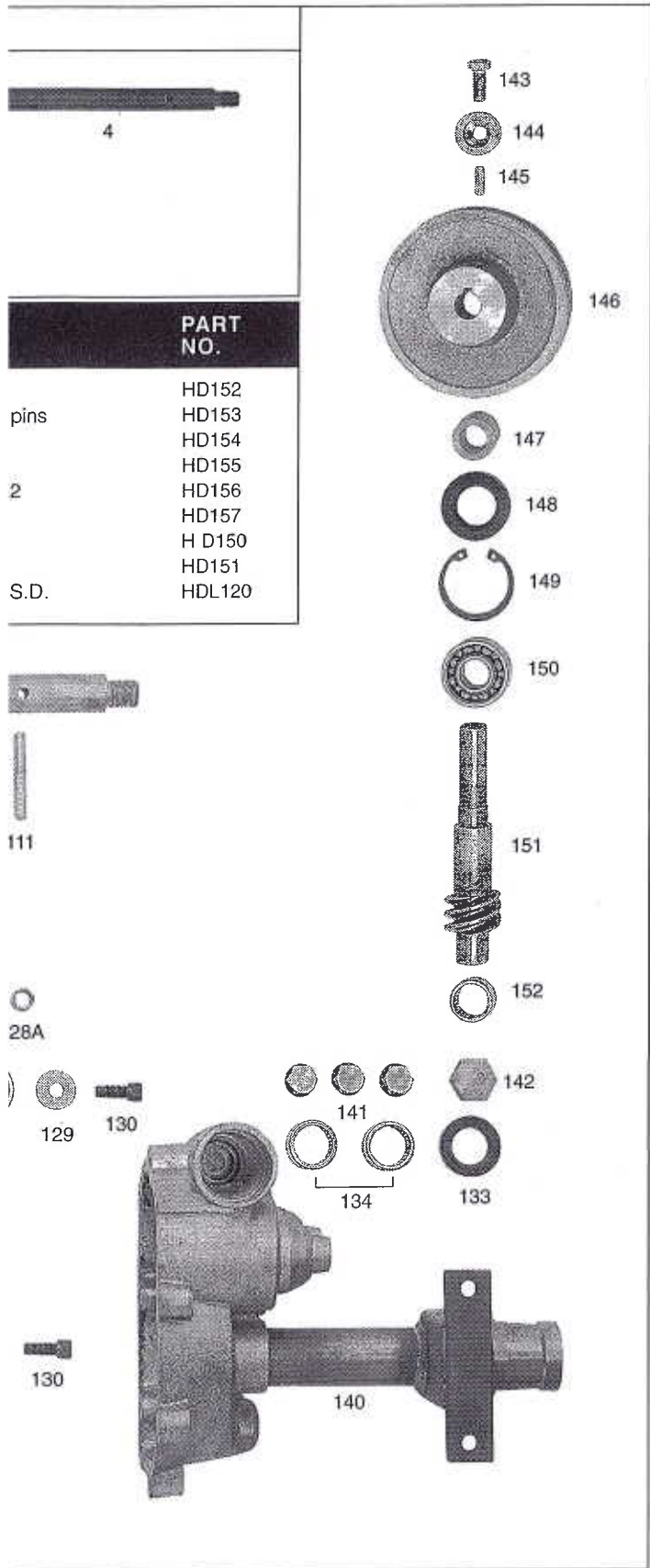

ILLUSTRATION 4



ILLUST. NO.	DESCRIPTION	PART NO.
-------------	-------------	----------

100	Internal circlip	HD69
101	Gear selector arm	HD70
102	Gasket	HD71
103	2 x 1/4" UNF bolt x 6	YD72
105	1 1/4" x 5/16" WHIT bolt	HD74
106	Diff bolt	HD75
107	Low crown gear	HD76
108	Diff spacer sleeve	MRD179
109	High crown gear	HD77
110	Axle (LH & RH are identical)	HD78
111	Axle pin	HD79
112	Diff spider gear	RD178
113	Forward tappet & end	HD80
114	Reverse tappet & end	HD81
115	O Ring	RD133
116	Ball	HD82
117	Spring	HD83
118	Spring Holder	HD84
119	Roller bearing (B98)	HD85
120	Circlip (9/16")	HD86
121	Low gear pinion (9 teeth)	HD87
122	Double-clutch	HD88
123	Forward spindle	HD89
124	High gear pinion & clutch	HD90
125	Bronze worm gear	HD91
125A	Hardened worm gear washer	HD114
126	Small Reverse gear 13 teeth	HD92
127	Circlip 35mm	HD93
128	Ball bearing (6202)	Z35
128A	Bearing sleeve	HD115
129	Washer	HD94
130	Screw	HD95
131	Selector guide	HD96
132	Selector guide bolt	HD97
133	Oilseal 7/8" x 1 3/8" x 1/4"	DD90
134	Roller Bearing (B148)	Z50
135	L.H. housing	HD98
136	Reverse sliding gear	HD99
137	Reverse clutch	HD100
138	Reverse spindle complete with Reverse Gear 17 teeth	HD101
140	R.H. housing	HD103
141	1/2" BSF plug & washer	
141A	Fibre washer only 1/2"	MDD98
142	3/4" UNF plug & washer (filler & level)	HD117
142A	Fibre washer only 3/4"	HD104
143	Pulley screw	HD116
144	Collar washer	HD105
145	Key	HD106
146	Pulley	HD107
147	Spacer washer	HD108
148	Oil seal 25 x 40 x 7	HD109
149	Circlip 40mm	HD110
150	Ball bearing (6203)	HD111
151	Input spindle & worm	HD112
152	Roller bearing (B128)	RD194
	Gear box complete	HD120
	Rear wheel c/w tyre & tube	HD121
	Tyre only	HD122
	Tube only	T564
	Wheel only	HD123
	Axle nuts (5/8" UNF)	RD174
	Axle washer	HD124
	Axle spring washer	RD175

CUTTER HEAD

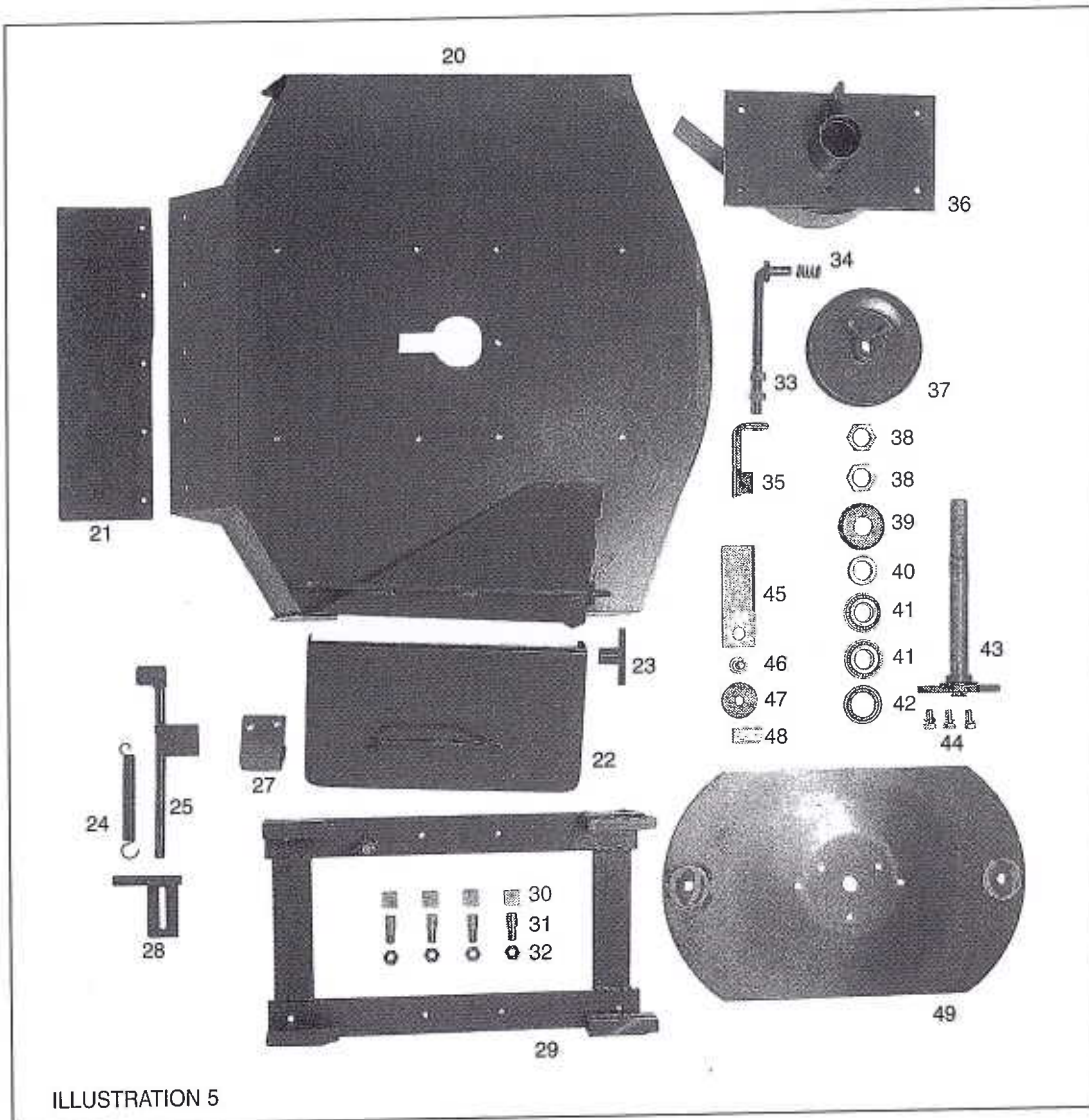

ILLUSTRATION 5

ILLUST. NO.	DESCRIPTION	PART NO.
20	Main guard	H10
21	Rubber flap	G21
22	Side flap	H11
23	Flap wing nut	G37
24	Brake tension spring	H15
25	Brake lever	H28
27	Brake pad	Y28
28	Brake lever stop	H19
29	Raise & lower frame	H20
30	Square lift block	H21
31	Pin	H22
32	Nut 7/16" UNF	H23
33	Push rod	H24
34	Push rod spring	D134
35	Push rod connector	H26

ILLUST. NO.	DESCRIPTION	PART NO.
36	Main spindle bearing housing	H27
37	Main spindle pulley	D10
37A	Pulley set screw	H25
38	Main spindle lock nut	G30
39	Main spindle dust cap	G31
40	Main spindle spacer washer	G32
41	Tapered roller bearing (30205)	G33
42	Oil seal	G34
43	Main spindle & flange	H29
44	Rotor plate bolts	G36
45	Blade	R01
46	Blade bolt	D02
47	Blade washer	D04
48	Blade nut	D03
49	Rotor plate	D5/26

HANDLE & CONTROL ASSEMBLY

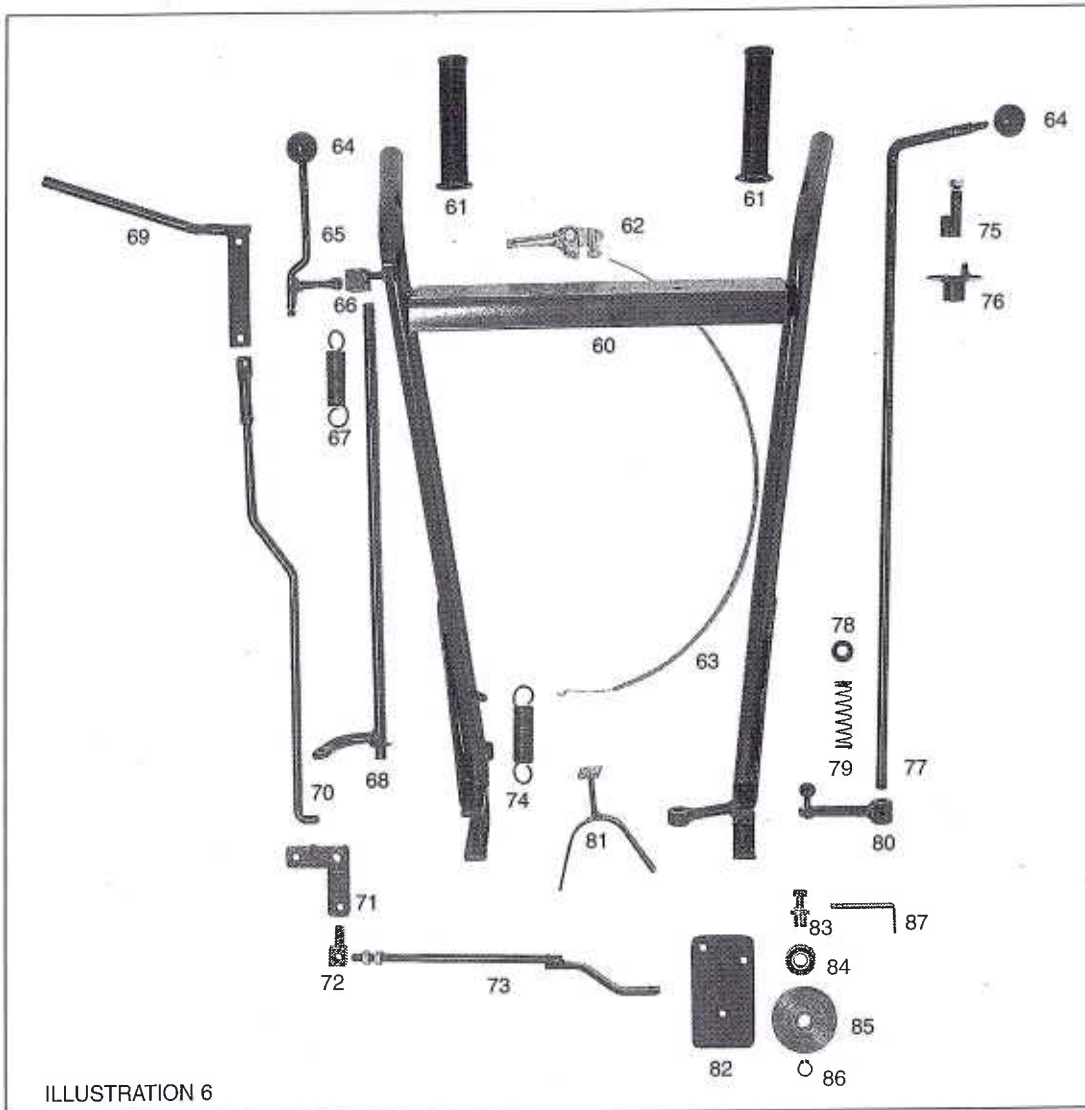

ILLUSTRATION 6

ILLUST. NO.	DESCRIPTION	PART NO.
60	Handles	H40
61	Handle grip	D19
62	Throttle control lever	Z08
63	Throttle control cable	H41
64	Knob	D42
65	Raise & lower lever	H42
66	Lever block	H43
67	Raise & lower tension spring	R46
68	Vertical raise & lower rod	H44
69	Clutch lever	H45
70	Vertical clutch rod	H46
71	Crank arm	H47
72	Pivot pin	H48
73	Horizontal clutch adjusting rod	H49
74	Clutch lever return spring	H50
75	Neutral guide	H51
76	Gear selector plate	H52
77	Gear lever	H53
78	Collar	H54
79	Spring	H55
80	Gear leverarm & ball	H56
81	Belt guide	H57
82	Clutch pulley plate	H58
83	Clutch pulley pin	H59
84	Clutch pulley bearing (6202-2RS)	H60
85	Clutch pulley	H61
86	Circlip (15mm)	H62
87	Belt guide	H63

PETROL TANKS & ELECTRICALS

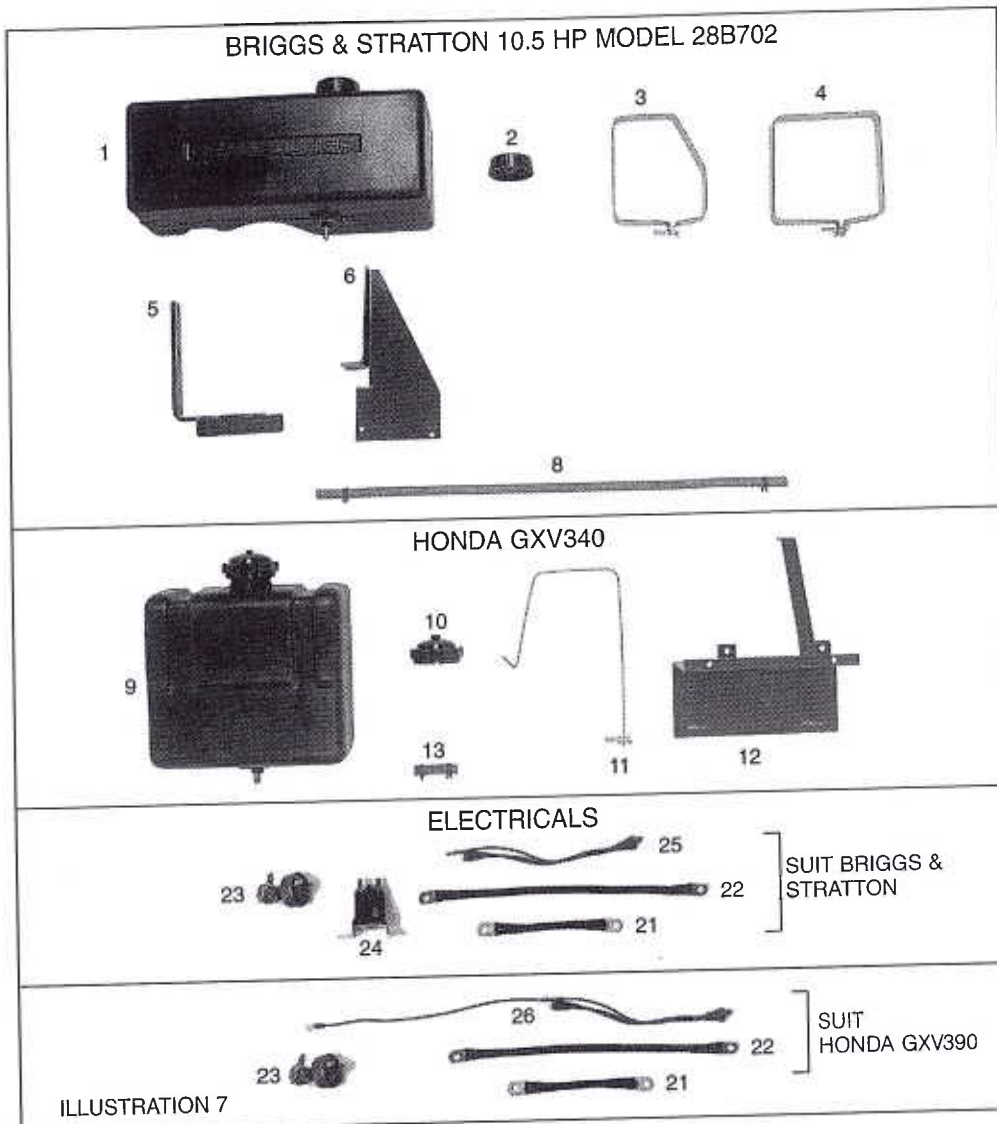

ILLUSTRATION 7

ILLUST. NO.	DESCRIPTION	PART NO.	ILLUST. NO.	DESCRIPTION	PART NO.
1	Tank (Briggs & Stratton)	R260	21	6" cable	R312
2	Tank cap	R261	22	13" cable	R323
3	Angle tank strap	R262	23	Key starter switch/Keys	R320
4	Square tank strap	R263	24	Solenoid	T302
5	Rear tank bracket (Briggs & Stratton)	R264	25	Wiring Loom (Briggs)	R324
6	Front tank bracket (Briggs & Stratton)	R265	26	Wiring Loom (Honda)	R322
8	Hose and clamps (Briggs & Stratton)	R266			
9	Tank (Honda)	R280			
10	Tank cap	R281			
11	Tank strap x 2	R282			
12	Tank bracket	H283			
13	Short hose & clamps (Honda)	R284			

SUNDRY PARTS

DESCRIPTION	PART NO.
Paint Deutscher green 1 Litre	D2720
Instruction & parts manual	H405
Decal set	H410
Swivel wheel conversion	H517
Trailer seat	H530
Height adj. lever rack	H518
Front skirt for H20 guard	H519