

---

**DEUTSCHER**

**MODEL "R"**

**280 & 360**

**RIDE-ON MOWER**

**OPERATOR  
&  
PARTS MANUAL**

---

# SAFETY INSTRUCTIONS

- Never mow while barefoot or wearing open sandals, or thongs. Wear long trousers and heavy shoes (preferably safety footwear).
  - Know your controls. Read this booklet carefully. Learn how to stop engine quickly in any emergency.
  - Make sure the lawn is clear of sticks, stones, bones, wire and debris. They could be thrown by the blades.
  - Stop the engine and disconnect spark plug wire before checking or working on the mower.
  - Before using, always visually inspect to see that blades, blade pins and cutter assembly are not worn or damaged. Replace worn or damaged blades and pins in sets to preserve balance.
- DAMAGED BLADES AND WORN PINS ARE MAJOR HAZARDS.**
- Check all nuts, bolts and screws often; always be sure the mower is in safe operating condition. Use only replacement parts made and guaranteed by DEUTSCHER.
  - Add fuel **BEFORE** starting engine. Avoid spilling petrol and do not fill the tank while engine is running or while you are smoking.
  - Do not mow whilst people, especially children, or pets are in the mowing area.
  - Never use the mower unless the grass catcher, or guards provided by the manufacturer, are in position.
  - Disengage all blade and drive clutches before starting.
  - Start the engine carefully with feet well away from the blades.
  - Do not operate engine in a confined space where exhaust fumes (carbon monoxide) can collect.
  - Stop the engine whenever you leave the mower, even for a moment.
  - Disengage cuttershaft drive before moving mower across gravel drives, walks or roads.
  - Do not allow children or people unfamiliar with these instructions to use the mower.
  - On slopes or wet grass, be extra careful of your footing.
  - Never cut grass by pulling the mower towards you.
  - Be extremely careful when using a riding mower on slopes.
  - Do not over-speed the engine or alter governor settings. Excessive speed is dangerous and shortens mower and engine life.
  - It is advisable to wear suitable eye protection when operating a mower.
  - Turn the fuel off at the conclusion of mowing and reduce the throttle setting during engine run-out.
  - Store fuel in a cool place in a container specifically designed for the purpose. In general, plastic containers are unsuitable.
  - Never pick up or carry a mower when it is operating.
- NOTE: These safety instructions are recommended by the Standards Association of Australia for use with pedestrian and ride-on mowers.

**Deutscher**

**WHEN ORDERING PARTS  
SPECIFY THE MODEL AND SERIAL NUMBER  
ON THE NAME PLATE OF THE MOWER  
AND THE PART NUMBER IN THIS MANUAL**

**THE MANUFACTURERS RESERVE THE RIGHT TO ALTER, CHANGE OR VARY THE  
SPECIFICATIONS OF THE MACHINE OR ANY OF THE COMPONENT PARTS  
AT ANY TIME WITH OUT NOTICE**

## STARTING INSTRUCTIONS

Your Deutscher Rider Mower comes to you tested and ready to operate with engine, oil-filter and gearbox already filled with oil. Requires only motor spirit.

Before operating machine, thoroughly inspect the area to be cut and remove any object which may cause damage to the machine.

### BEFORE STARTING

1. Read Engine Instruction book.
2. Set blades to suitable height.
3. Make sure Forward-Reverse Lever is in neutral and Speed lever is in brake position.
4. Pull Cutter Belt Release Lever to backward position. Set throttle and choke. Start according to Engine Instruction Book.
5. Wait a few moments for engine to warm up, then push belt lever to forward position.
6. Set engine at suitable speed to ensure clean cutting, release brake and select required ground travel speed.

Don't operate engine at maximum speed unless heavy conditions warrant it.

Forward-reverse lever can only be engaged when speed lever is in brake position.

### TO ADJUST TRANSMISSION BELT

If mower does not move off in position one of Variable Speed Lever, adjust by shortening speed control rod, Part no. RD121, which passes through frame on L.H. side of engine.

Unscrew lock nut, remove split pin then screw down top link.

When belt is very worn, it may be necessary to further adjust by sliding engine back in slots.

### TO REPLACE TRANSMISSION BELT

1. Remove back plate (rear of engine).
2. Remove complete sliding assembly from engine crankshaft by unscrewing (R.H. thread) using stilson wrench around boss of pulley.
3. Replace belt, re-assemble and adjust.

### TO ADJUST CUTTER DRIVE BELT.

On 28in. single spindle machine, loosen four bolts holding cutter head to guard and pull forward. Tighten bolts.

On 36in. twin spindle machine, loosen two bolts holding cutter assembly to guard and pull forward. Tighten bolts.

Do not move engine back to adjust cutter belt as this will alter transmission drive adjustment.

### TO REPLACE CUTTER DRIVE BELT.

1. Remove handles and column by loosening set screw in steering arm, Part no. R85.
2. Remove belt cover.
3. Loosen belt adjustment bolts, four in 28in. single spindle machine, two in 36in. twin spindle machine.
4. Remove top bolt of telescopic joint, Part no. R51.
5. Remove back plate (rear of machine).
6. Remove complete sliding pulley assembly from engine crankshaft by unscrewing (R.H. thread) using stilson wrench around boss of pulley.
7. Replace belt, re-assemble and adjust.

### BELT ADJUSTMENT

Maintain belt at correct tension. too much or too little wastes power.

## TWIN SPINDLE DRIVE BELT

(Cover Removed)

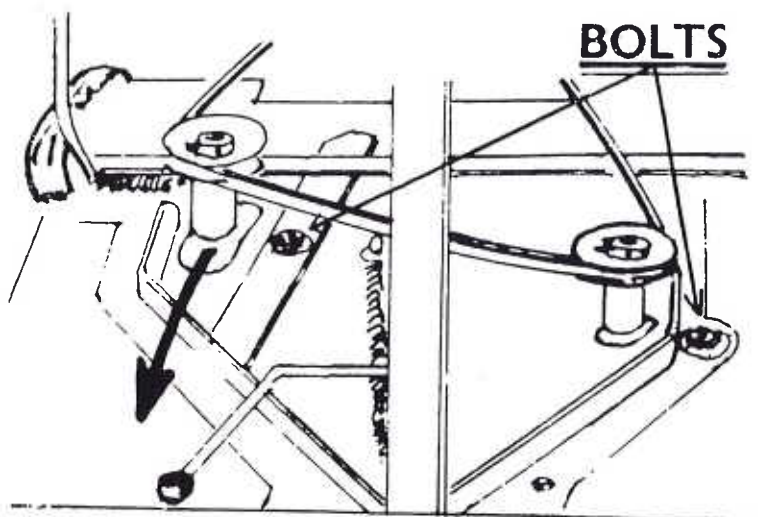

### BLADES

Keep blades sharp. Blades can be removed without spanner. Rotate cutter till blade appears at front. Unscrew special brass nut, remove spring washer and blade assembly can be extracted from underneath. Oil thread and bolt and replace by reverse procedure. Screw nut on by hand firmly and then slacken one quarter turn.

Both edges of blades can be used by turning blade over.

## IMPORTANT

- **OIL.** Your engine needs GOOD OIL — CLEAN OIL — ENOUGH OIL. Each five hours add oil to top level of filler opening.
- **AIR CLEANER.** Service air cleaner every 25 running hours under normal conditions. Under dusty conditions, **EVERY FOUR HOURS.**
- **OIL BATH TYPE:** Clean and refill with engine oil to oil level mark.
- **OIL FOAM TYPE:** Wash foam element in petrol or kerosene, squeeze out dry. Saturate element with engine oil. Squeeze element to distribute and remove excess oil.
- **DRY TYPE:** Remove element from housing and tap lightly to dislodge dirt. Wipe inside of housing to remove all dirt, replace element. **CAUTION - Do not wash or oil this element.**
- **PETROL:** Use clean, fresh standard grade.  
DO NOT MIX OIL WITH PETROL.
- **COOLING FINS — SCREEN.** This engine is air-cooled. Keep the blower screen, fins on flywheel, cylinder head and block free from grass or dirt. Check every eight hours. Clogged fins and screens block air flow, causing over-heating, which results in serious damage to engine. Remove blower housing and clean regularly.



# LUBRICATION

## DAILY

OIL STEERING JOINTS (3)  
 OIL TELESCOPIC BALL JOINT (1)  
 OIL RAISE/LOWER CONTROL BAR BEARINGS (2)  
 OIL FORWARD/REVERSE LEVER BEARING (1)  
 OIL SPEED CONTROL LEVER BEARING (1)  
 AND JOINTS (3)  
 OIL BRAKE SHAFT BEARINGS (2)  
 GREASE CUTTER GUARD WHEELS

## DIFF. POINTS

(Cover Removed)

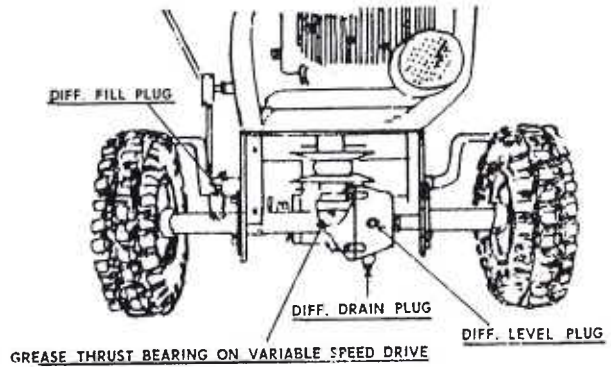

## EVERY 50 HOURS

GREASE KINGPINS (2)  
 GREASE STEERING COLUMN CENTRE (1)  
 GREASE FRONT WHEEL BEARINGS (2)  
 GREASE CUTTER SPINDLE (1), TWIN SPINDLE (2)  
 GREASE THRUST BEARING ON VARIABLE  
 SPEED DRIVE (1)  
 DRAIN AND REFILL DIFF. WITH CASTROL Hypoy  
 Gear Oil 90 SHOULD BE DONE WHILE OIL  
 IS WARM.  
 DRAIN AND REFILL ENGINE (SEE INSTRUCTION  
 MANUAL).

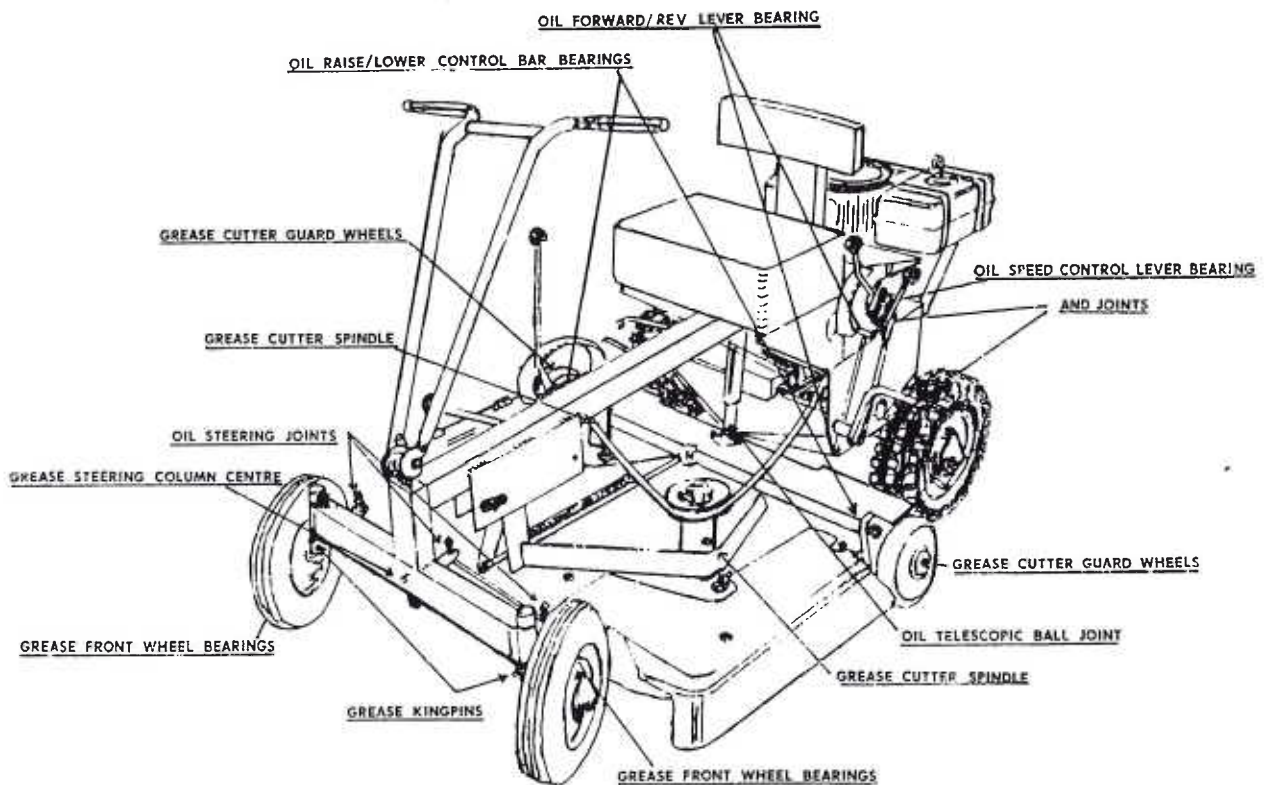

## LUBRICATION POINTS (COVER REMOVED)

## 36" CUTTER SPINDLE ASSEMBLY

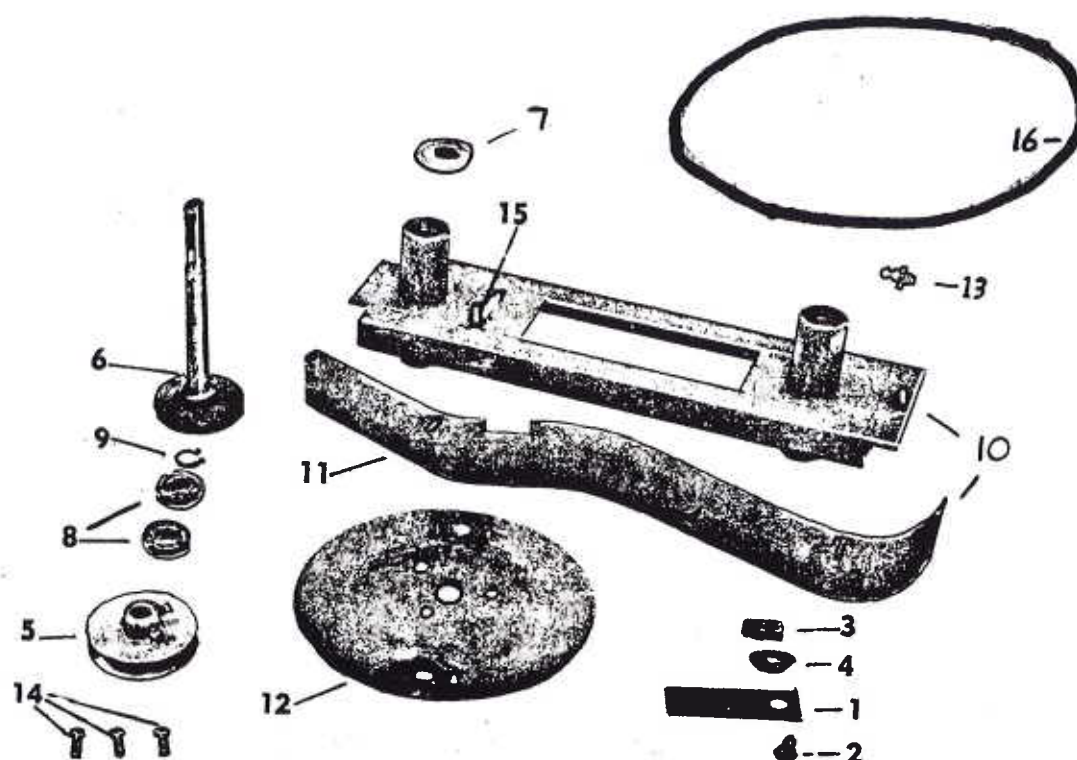

<u>Illus. No.</u>	<u>Description</u>	<u>Part No.</u>
1	BLADE x 4	R01
2	BLADE BOLT x 4	D02
3	BLADE NUT x 4	D03
4	BLADE WASHER x 4	D04
5	PULLEY x 2	R25
6	SPINDLE & FLANGE x 2	R06
7	DUST CAP x 2	D09
8	BEARING 6205NRS x 4	R28
9	CIRCLIP x 2	R29
10	HOUSING & DEFLECTOR	R30/31
11	DEFLECTOR PLATE	R31
12	BLADE PLATE x 2	R32
13	GREASE NIPPLE x 2	R13
14	SET SCREW & S/WASHER x 6	G36
15	ADJUSTMENT BOLT	R35
16	CUTTER BELT (B85)	R36

## 28" CUTTER SPINDLE ASSEMBLY

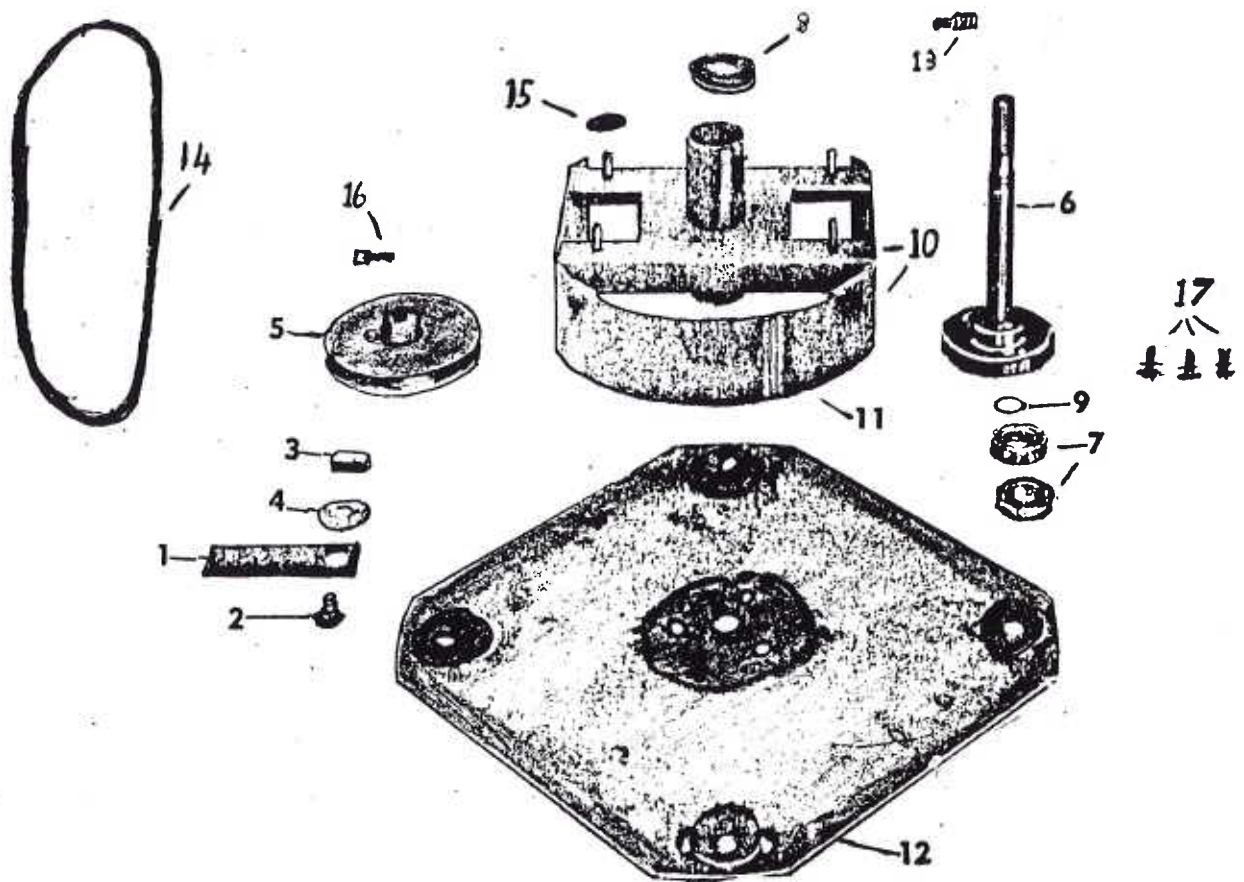

<u>Illus. No.</u>	<u>Description</u>	<u>No. Required</u>	<u>Part No.</u>
1	BLADE	4	R01
2	BLADE BOLT	4	D02
3	BLADE NUT	4	D03
4	BLADE WASHER	4	D04
5	PULLEY	1	R10
6	SPINDLE & FLANGE	1	R06
7	BEARING (6205NRS)	2	R28
8	DUST CAP	1	D09
9	CIRCLIP	1	R29
10	HOUSING & DEFLECTOR	1	R10/11
11	DEFLECTOR PLATE	1	R11
12	BLADE PLATE	1	R12
13	GREASE NIPPLE	1	R13
14	CUTTER BELT (B66)	1	R14
15	WASHER	4	DD111
16	SET SCREW, PULLEY	2	H25
17	SET SCREW, BLADE PLATE	3	G36

## 28" COVER ASSEMBLY

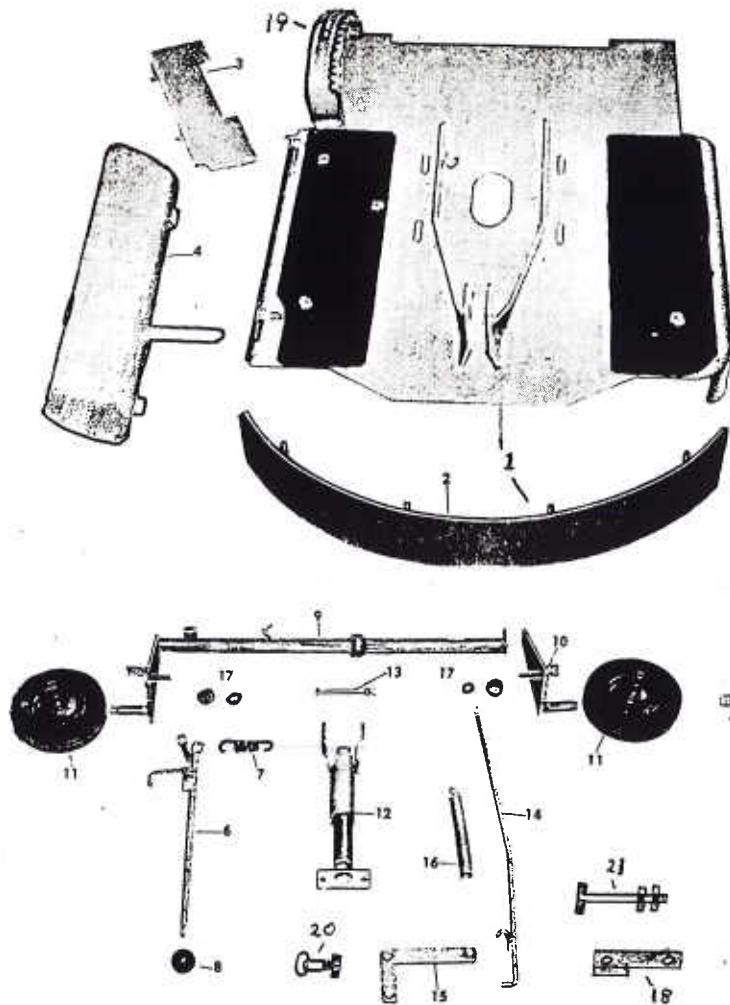

<u>Illus. No.</u>	<u>Description.</u>	<u>Part No.</u>
1	MAIN GUARD INC. FRONT SKIRT	R40/41
2	FRONT SKIRT	R41
3	DEFLECTOR PLATE	R42
4	SIDE FLAP	R43
5	SCREW & WASHER	G02
6	LEVER, RAISE & LOWER	R45
7	SPRING, R&L. LEVER	R46
8	KNOB	D42
9	CROSS BAR	MR48
10	STUB AXLE & PLATE	MR49
11	WHEEL COMPLETE	MR50
-	TYRE	R57
-	BEARING, WHEEL (6205Z)	MD18
12	SWIVEL JOINT	R51
13	BOLT, CHASSIS TO S/JOINT	R52
14	ROD, CONNECTING	R53
15	LINK, CONN. ROD	R54
16	SPRING	D50
17	NUT & WASHER	R78
18	LINK BRACKET	R59
19	HEIGHT RACK	R225
20	BOLT & NUT (ROUND HEAD)	R76
21	BOLT, 4"x1/2"w	R515
--	DECK ASSEMBLY INCLUDING SPINDLE ASSEMBLY	R2828



### 36" COVER ASSEMBLY

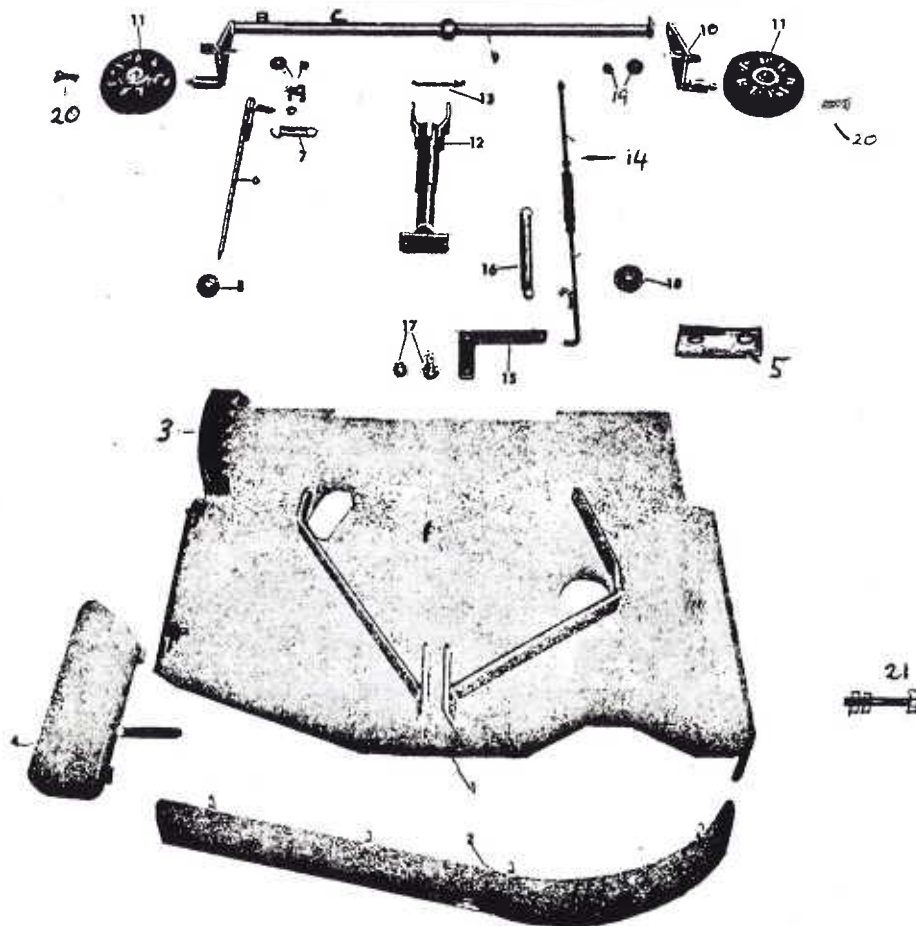

<u>Illus. No.</u>	<u>Description</u>	<u>Part No.</u>
1	MAIN GUARD & FRONT GUARD	R60/61
2	FRONT GUARD	R61
3	HEIGHT QUADRANT	R225
4	SIDE FLAP	R63
5	LINK BRACKET	R59
6	RAISE & LOWER LEVER	R45
7	LEVER SPRING	R46
8	KNOB	D42
9	CROSSBAR	R68
10	STUB AXLE & PLATE	R69
11	WHEEL	R70
12	SWIVEL JOINT	R51
13	BOLT	R52
14	CONNECTING ROD	R73
15	LINK, CONNECTING ROD	R54
16	SPRING	D50
17	CONNECTING BOLT & NUT	R76
18	WASHER 2"	R77
19	NUT & WASHER	R78
20	TAPER SCREW	R309
21	BOLT, FRONT DECK SUPPORT	R515
-	WHEEL BEARING	R18
-	TYRE	R57
-	FOOT PAD	R401

## FRONT END AND STEERING ASSEMBLY

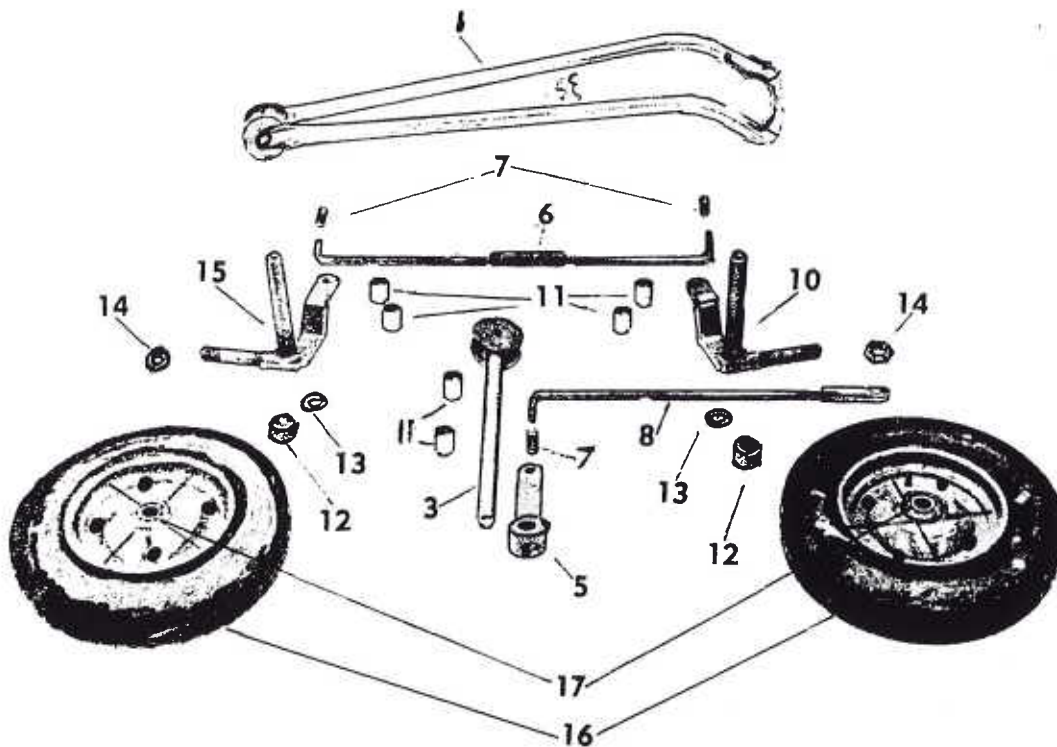

<u>Illus. No.</u>	<u>Description.</u>	<u>Part No.</u>
1	HANDLES	R81
3	STEERING COLUMN	R83
5	STEERING ARM	R85
6	FRONT TIE ROD	R86
7	SPRING	R87
8	REAR TIE ROD	R88
10	KING PIN & STUB AXLE L.H.	MR95
11	BUSH	R91
12	COLLAR	R92
13	THRUST WASHER	R93
14	AXLE NUT	RD174
15	KING PIN & STUB AXLE R.H.	MR95
16	WHEEL ASSEMBLY	R98
17	WHEEL BEARING 6205z	MR97
—	TYRE 410-350-6	MDD116
—	TUBE 410-350-6	RD204
—	HUB CAP	R100
—	WHEEL RIM inc. BEARINGS	R99

## VARIABLE SPEED DRIVE ASSEMBLY

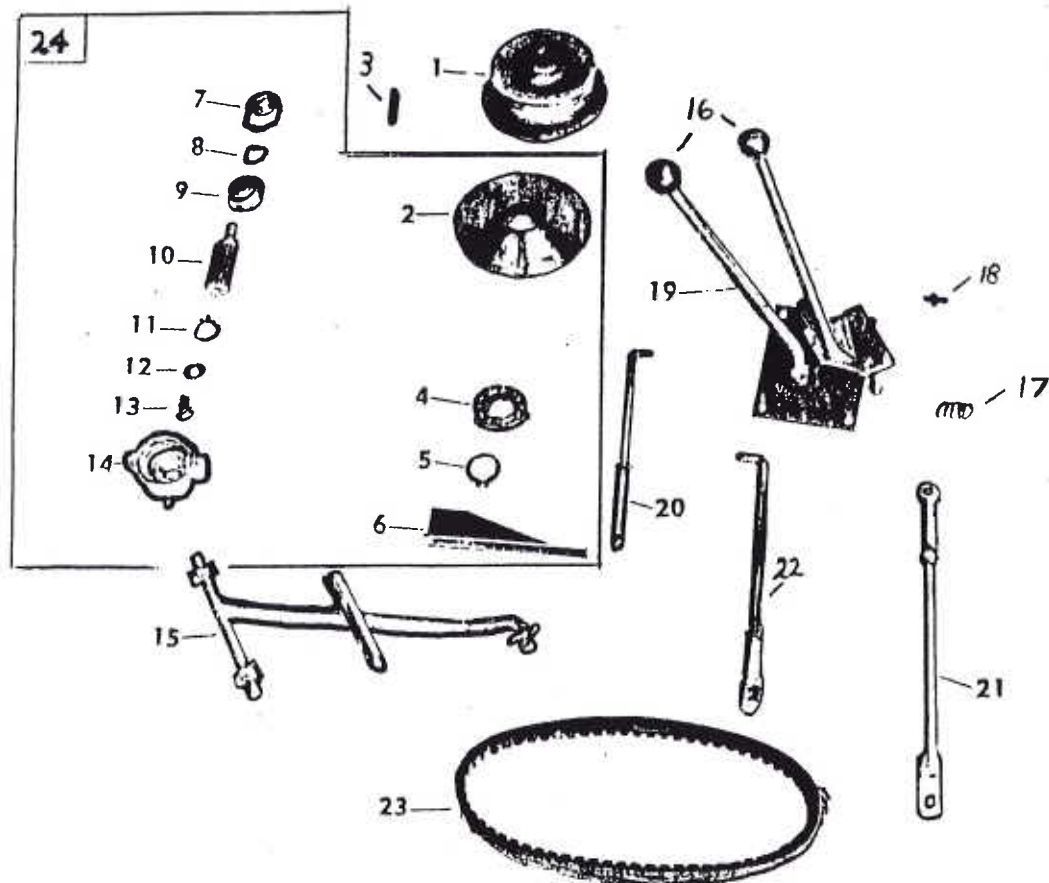

<u>Illus. No.</u>	<u>Description</u>	<u>Part No.</u>
1	ENGINE PULLEY (280, 4")	RD101/4
-	ENGINE PULLEY (360, 4.5")	RD101/4.5
2	BOTTOM SHEAVE	RD102
3	KEY	RD126
4	THRUST BEARING, 6006N	RD104
5	CIRCLIP 30mm	RD105
6	STOP PLATE	RD106
7	SLEEVED BEARING	RD107
8	WASHER	RD108
9	SLEEVE	RD109
10	SPLINE SHAFT	RD110
11	CIRCLIP 25mm	R29
12	WASHER	RD112
13	SCREW	RD113
14	BEARING HOUSING	RD114
15	BOTTOM LEVER	RD115
16	KNOB	D42
17	SPRING	R87
18	GREASE NIPPLE	R13
19	LEVER ASSEMBLY	RD124
20	GEAR CHANGE ROD	RD120
21	SPEED CONTROL ROD	RD121
22	BRAKE ROD	RD122
23	BELT	RD123
24	PULLEY ASSEMBLY COMPLETE	RD125

## FORWARD & REVERSE CONTROL

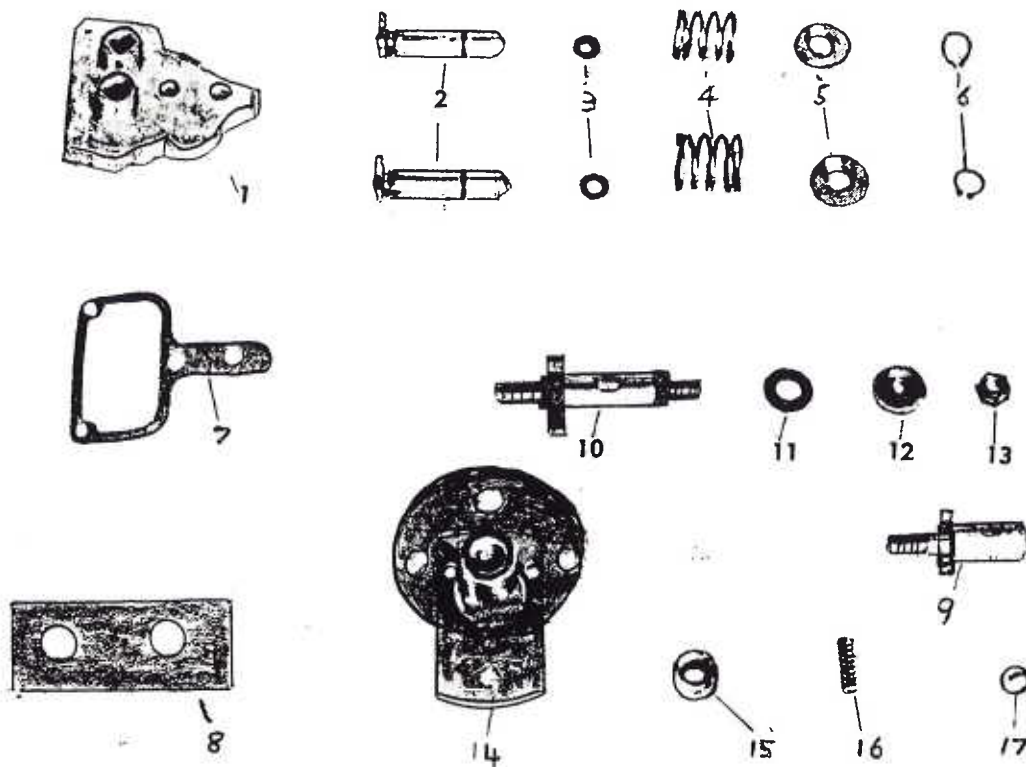

<u>Illus. No.</u>	<u>Description</u>	<u>Part No.</u>
1	SIDE CASTING	RD130
2	SELECTOR TAPPET	RD132
3	O-RING	RD133
4	SPRING	RD134
5	CAP, SPRING	RD135
6	CIRCLIP, 5/8" ex.	RD136
7	GASKET	RD137
8	LOCKING TAB	RD129
9	HOLDER, BALL & SPRING	RD149
10	PIVOT SPINDLE	RD139
11	THRUST RACE	RD140
12	CAP NUT	RD141
13	LOCK NUT	RD142
14	CAM PLATE ASSEMBLY inc. BUSH	MRD143
15	BUSH	RD146
16	SPRING, NEUTRAL	RD147
17	BALL. NEUTRAL	RD148



## INPUT SPINDLE ASSEMBLY

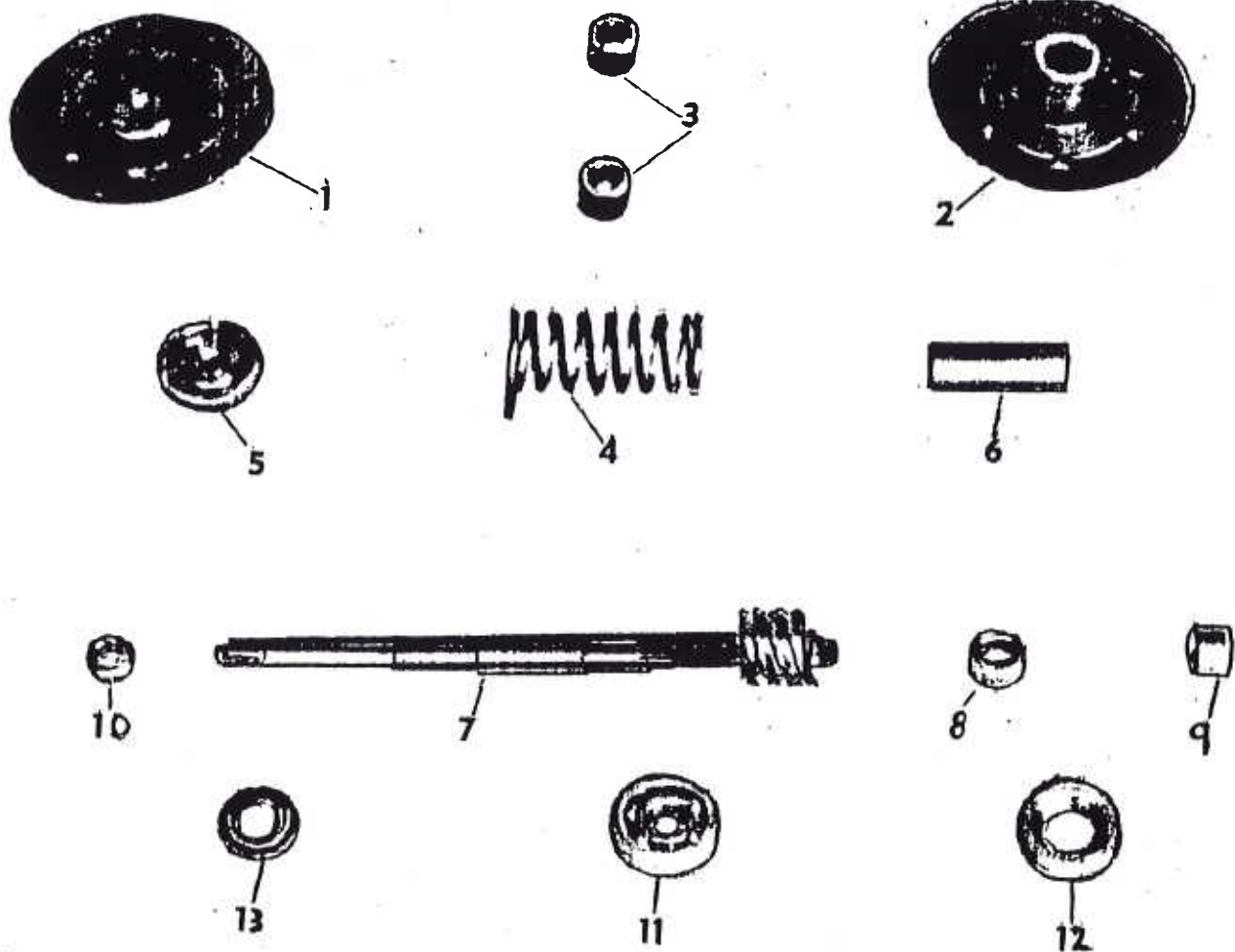

<u>Illus. No.</u>	<u>Description.</u>	<u>Part No.</u>
1	BOTTOM PULLEY SHEAVE	RD150
2	TOP PULLEY SHEAVE inc. BUSHES	RD151/2
3	SHEAVE BUSHES	RD152
4	SPRING	RD153
5	SPRING CAP	RD154
6	SLIDING PULLEY SLEEVE	RD155
7	INPUT SPINDLE & GEAR	RD156/7
8	ROLLER BEARING (B128)	RD194
9	PLUG	RD161
10	TOP SPACER	RD162
11	BALL BEARING (RMS5)	RD163
12	OIL SEAL HOLDER	RD164
13	OIL SEAL	DD90

## DIFFERENTIAL & GEARBOX

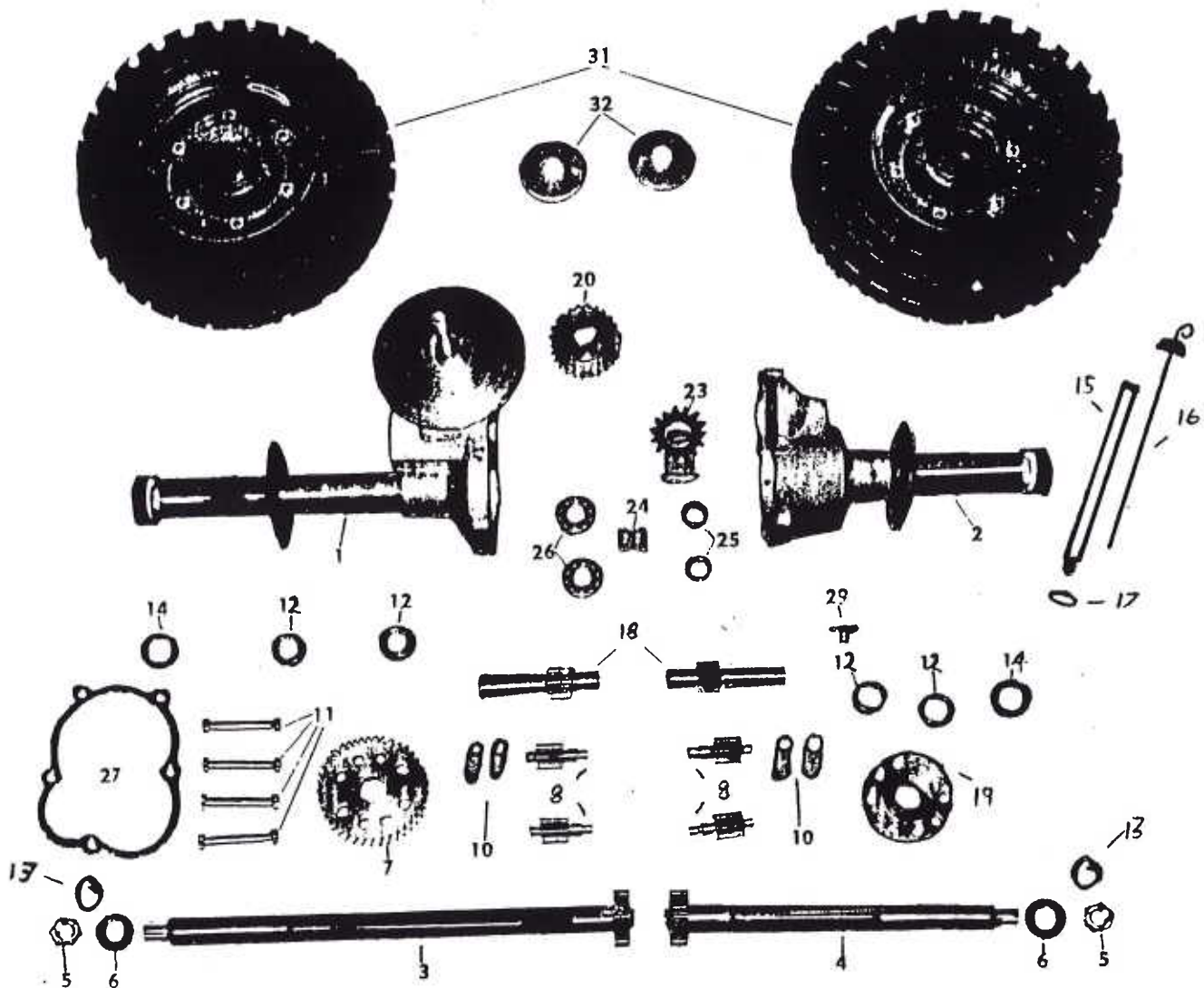

<u>Illus.</u>	<u>Description</u>	<u>Part No.</u>	<u>Illus.</u>	<u>Description</u>	<u>Part No.</u>
1	MAIN HOUSING L.H.	RD170	19	SIDE PLATE, DIFF	RD177
2	MAIN HOUSING R.H.	RD171	20	BRONZE & GEAR	RD189/190
3	AXLE, L.H. to s/n. 11010	RD172	23	REVERSE GEAR	RD191/2
4	AXLE, R.H. to s/n. 11010	RD173	24	KEEPER PLATE	RD193
	SPIRAL TEETH from s/n. 11011.	RD172S	25	NEEDLE BEARING	RD194
	SPIRAL TEETH from s/n. 11011.	RD173S	26	BALL BEARING	RD195
5	NUT 5/8"unf	RD174	27	GASKET	RD196
6	FLAT WASHER	RD175	29	DRAIN PLUG	MDD98
7	CROWN GEAR	RD176	31	WHEEL ASSEMBLY	RD200
8	SPIDER GEAR to s/n. 11010.	RD178A	32	CAP	RD201
	SPIRAL TEETH from s/n. 11011.	RD178SL	--	WHEEL RIM	RD202
	R.H.	RD178SR	--	TYRE	HD122
10	SPACERS	MRD179	--	TUBE	RD204
11	BOLT, HIGH TENSILE	RD180	--	DUAL WHEEL ASSE.	RD205
12	BEARING, AXLE ROLLER	RD181	--	DUAL WHEEL RIM	RD206
13	SPRING WASHER	HD124	--	DRIVE WASHER	R300
14	SEAL	RD186	--	GEARBOX COMPLETE	RD250S
15	OIL FILLER TUBE	RD197	--	GASKET & SEAL KIT	RD400
16	DIPSTICK	RD198			
17	FIBRE WASHER	HD116			
18	SLIDING PINION	RD188			

## FUEL TANK ASSEMBLY

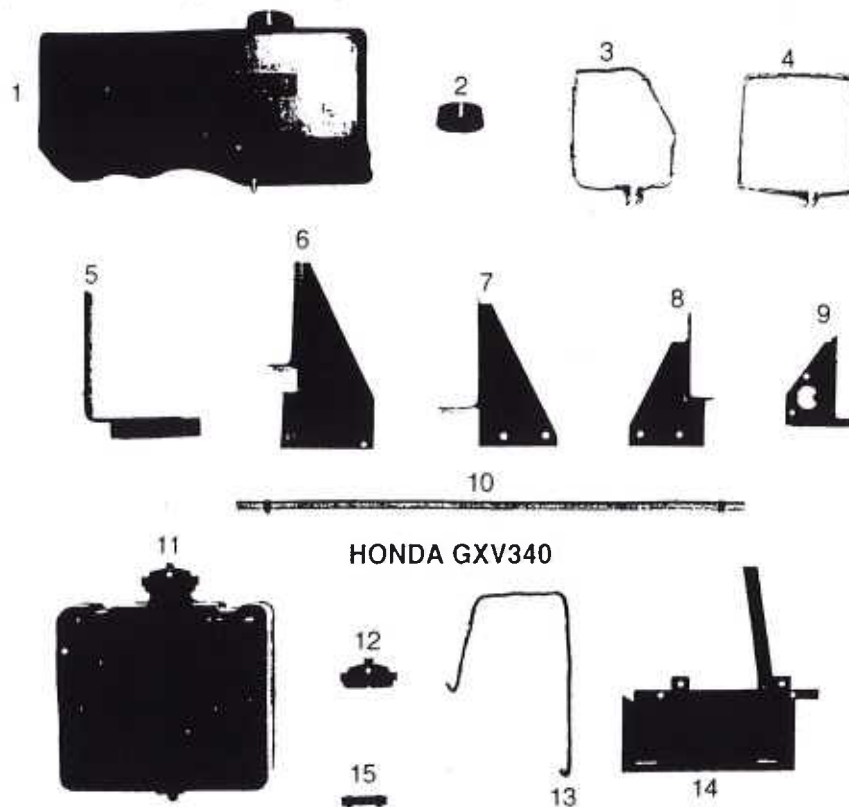

**BRIGGS & STRATTON 10hp & 12hp .**

**HONDA GV400 11hp.**

<b><u>ILLUST. No.</u></b>	<b><u>DESCRIPTION.</u></b>	<b><u>PART No.</u></b>
1	TANK, "DEUTSCHER"	R260
2	TANK CAP	R261
3	STRAP, ANGLE	R262
4	STRAP, SQUARE	R263
5	BRACKET, 10 & 12 hp B&S	R264
6	BRACKET, 12hp B&S	R265
7	BRACKET, 10 hp. B&S	R265A
8	BRACKET, GV400	R268
9	BRACKET, GV400	R267
10	HOSE & CLAMPS, 10 & 12 hp. B&S 770mm	R266

### **HONDA GXV340 11hp.**

11	TANK	R280
12	TANK CAP	R281
13	TANK STRAP x 2	R282
14	BRACKET	R285
15	HOSE & CLAMPS	R284

## ELECTRICAL SYSTEM

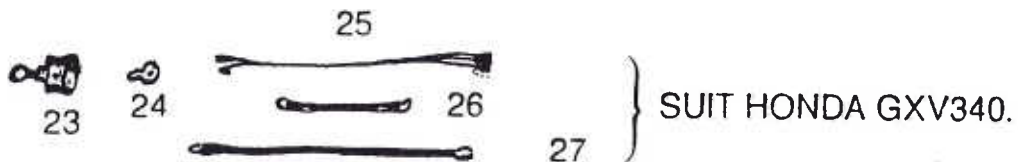
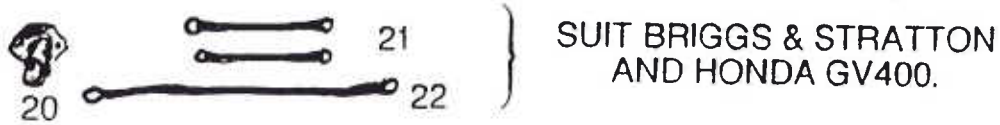

**BRIGGS & STRATTON 10hp & 12hp .                      HONDA GV400 11hp.**

<u>ILLUST. No.</u>	<u>DESCRIPTION.</u>	<u>PART No.</u>
—	BATTERY BOX	R310
20	STARTER SWITCH	R311
21	CABLE 6"	R312
22	CABLE 30"	R314
23	KEY STARTER SWITCH	R320
24	KEY	R321
25	WIRING LOOM	R322
26	CABLE 9"	R313
27	CABLE 13"	R323
—	BATTERY, (339)	R315

### HONDA GXV340 WIRING CODE.

<u>SWITCH -R320</u>	<u>WIRE COLOUR</u>	<u>PART</u>
M	BLACK (WHITE	CUT OUT SWITCH SEAT SWITCH)
B	BLUE	BATTERY - POSITIVE
S	WHITE	SOLENOID
L	RED	RECTIFIER

**WARNING :-** INCORRECT WIRING MAY RESULT IN DAMAGE TO THE ENGINES ELECTRICAL SYSTEM.



## SUNDRY PARTS NOT ILLUSTRATED

<u>Description.</u>	<u>Part No.</u>
THROTTLE CABLE, SHORT	RD208
THROTTLE CABLE, LONG, GXV340, (UNIVERSAL)	D130
THROTTLE LEVER	Z08
BRACKET & SPACER FOR GV400 THROTTLE	R220
BRACKET, B&S THROTTLE	R221
BRACKET, QUADRANT, SPEED LEVER CONTROL	R224
SEAT	R251
BACK REST	R252
BELT COVER, 360	R254
SEAT FRAME	R256
SEAT HINGE	R503
SEAT SPRING	R504
BRAKE ROD, LONG	R301
BRAKE ROD, SHORT	R302
BACK PLATE	R257
TOUCH UP PAINT, DEUTSCHER GREEN 1lt.	D2720
DECAL SET 280	R410-28
DECAL SET 360	R410-36

## NOTES

**NATIONAL CUSTOMER SERVICE**

**ROVER MOWERS LIMITED**

**CURTIN AVENUE  
EAGLE FARM QLD 4009**

**FREE CALL 1800 803 537**

**FREE FAX 1800 806 659**

**MANUFACTURED IN AUSTRALIA BY  
H.F. DEUTSCHER PTY. LTD.**

A.C.N.005 576 830

**711 CRESWICK ROAD  
BALLARAT 3350**